

NOTE:
Always keep the key **OUT** until final countdown.

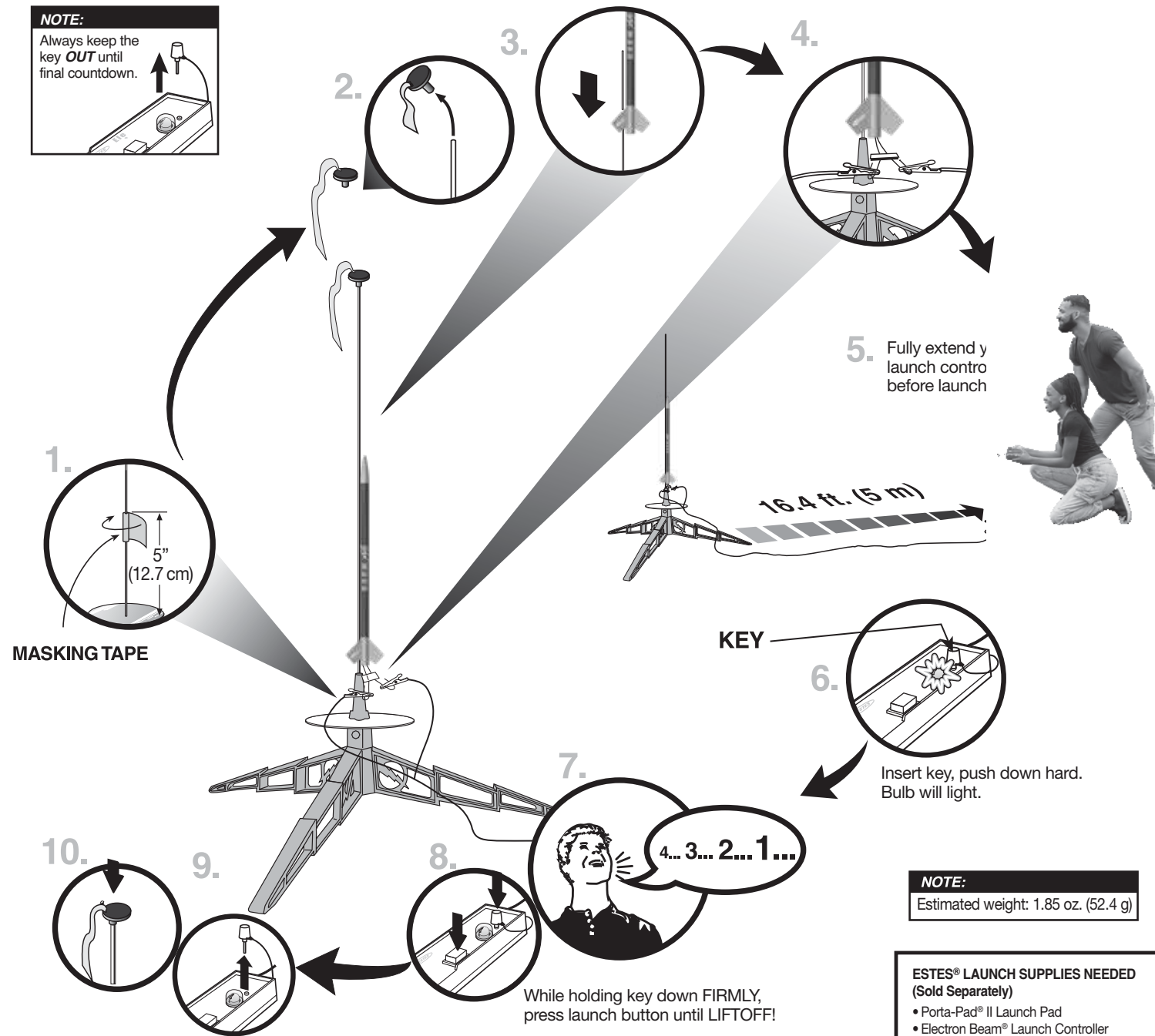

NOTE:
Estimated weight: 1.85 oz. (52.4 g)

ESTES® LAUNCH SUPPLIES NEEDED (Sold Separately)

- Porta-Pad® II Launch Pad
- Electron Beam® Launch Controller
- Recovery Wadding
- Starters (with engines)
- Plugs (with engines)
- Estes® Engines: A8-3, B6-4, C6-5

PRECAUTIONS



NAR SAFETY CODE



NO DRY GRASS OR WEEDS

PRE-LAUNCH CHECK For safety, never launch a damaged rocket. Check the rocket's body, nose cone and fins. Also, check the engine mount, recovery system and launch lug(s). Repair any damage before launching the rocket.

FLYING YOUR ROCKET Choose a large field (500 ft. [152 m] square) free of dry weeds and brown grass. The larger the launch area, the better your chance of recovering your rocket. Launch only with little or no wind and good visibility. Always follow the National Association of Rocketry (NAR) SAFETY CODE (enclosed).

MISFIRES TAKE THE KEY OUT OF THE CONTROLLER. WAIT ONE MINUTE BEFORE GOING NEAR THE ROCKET. Disconnect the micro-clips and remove the engine. Take the plug and starter out of the engine. A burned starter means the starter tip was not touching engine propellant. Install a new starter; be sure the tip is touching propellant inside the engine. Push the plug in place. Repeat steps under Countdown and Launch.



EstesRockets.com

D.O.R.M. 18™

3237

AGES
10+

Skill Level
BEGINNER



MODEL ROCKET INSTRUCTIONS

KEEP FOR FUTURE REFERENCE

IMPORTANT: Please record date found on decal and keep for future reference. _____

Read all instructions. Make sure you have all parts and supplies.

SUPPLIES



PLASTIC CEMENT YELLOW GLUE PENCIL

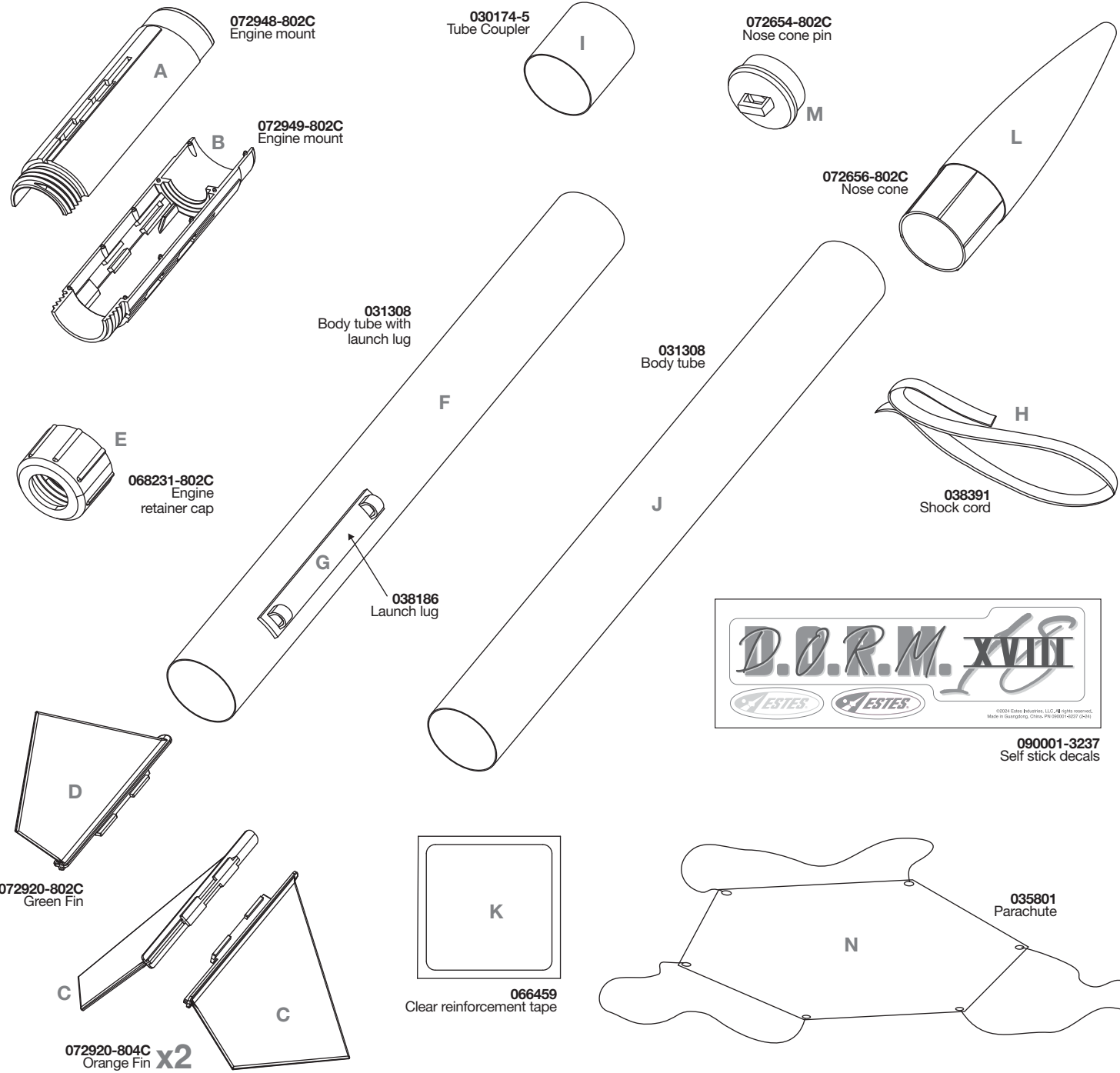

090001-3237
Self stick decals

ASSEMBLE ENGINE MOUNT AND FINS

1. Apply plastic cement to the edges of B.
2. Press A and B together for 20 seconds.
LET DRY
3. Insert fin C into slot in engine mount A/B.
4. Slide fin forward to lock into place.
5. Repeat for all 3 fins.
6. Screw engine retainer cap E onto engine mount A/B.
7. Screw engine retainer cap E onto engine mount A/B.

CAUTION:
For safe handling of plastic cement, see manufacturer's warnings and follow instructions for use.

x3

ASSEMBLE NOSE CONE

1. Apply plastic cement to the inside edge of nose cone L.
2. Insert nose cone pin M into nose cone L.
LET DRY
3. Test fit nose cone.

IF NOSE CONE FIT IS...

| | |
|-------------------|------------------|
| TOO LOOSE | TOO TIGHT |
| | |
| ADD MASKING TAPE. | SAND FOR FIT. |

INSTALL RECOVERY SYSTEM

1. Attach parachute N to the nose cone L.
2. Attach parachute N to the nose cone L.
3. Attach parachute N to the nose cone L.
4. Attach parachute N to the nose cone L. **DOUBLE KNOT**

ATTACH BODY TUBES TO ENGINE MOUNT

1. Pull shock cord H out of the front of body tube F.
2. Apply plastic cement to inside of body tube F.
3. Insert engine mount A/B into body tube F. Be sure to align launch lug G between fins.
4. Using a pencil, mark a line in the center of tube coupler I. Pull shock cord H through tube coupler I.
5. Apply yellow glue to the inside of tube F. Insert tube coupler I into tube F up to the pencil line.
6. Pull shock cord H through body tube J. Apply yellow glue to the inside of tube J.
LET DRY
7. Slide tube J over tube coupler I until the end of tube J meets tube F.
8. Apply clear reinforcement tape K over launch lug G.

PREPARE RECOVERY SYSTEM

1. Push recovery wadding down towards end of the body tube.
2. Push recovery wadding down towards end of the body tube.
3. Push recovery wadding down towards end of the body tube.
4. Push recovery wadding down towards end of the body tube.
5. Wrap parachute shroud lines loosely around the parachute N and insert into body tube J.

NOTE:
Recovery wadding and parachute must slide easily into body tube. If it's too tight, redo.

PREPARE ENGINE

1. Use one each. **ENGINE**, **STARTER**, **PLUG**
2. Use one each. **ENGINE**, **STARTER**, **PLUG**
3. **TIP MUST TOUCH PROPELLANT!**
4. **PLUG**
5. Use one each. **ENGINE**, **STARTER**, **PLUG**
6. Use one each. **ENGINE**, **STARTER**, **PLUG**

WARNING: FLAMMABLE
To avoid serious injury, read instructions & NAR Safety Code included with engines. **PREPARE YOUR ENGINE ONLY WHEN YOU ARE OUTSIDE AT THE LAUNCH SITE PREPARING TO LAUNCH.** If you do not use your prepared engine, remove the starter before storing your engine.