



estesrockets.com

# FIRECREST™

0640/1738/5334

AGES  
10+



Skill Level

**BEGINNER**

## MODEL ROCKET INSTRUCTIONS

KEEP FOR FUTURE REFERENCE

IMPORTANT: Please record date found on decal and keep for future reference. \_\_\_\_\_

### CAUTION:

May not apply to all kits. For safe handling of plastic cement, epoxy, spray adhesive, CA glue, CA accelerator, paint/finishing materials, see manufacturer's warnings and follow instructions for use. To avoid injury, use extreme caution when using hobby knife, scissors, drills, and any cutting tools.

### SUPPLIES



SCISSORS



YELLOW GLUE



PLASTIC CEMENT

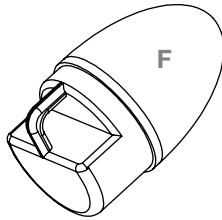

**073229-YELLOW C**  
Nose cone

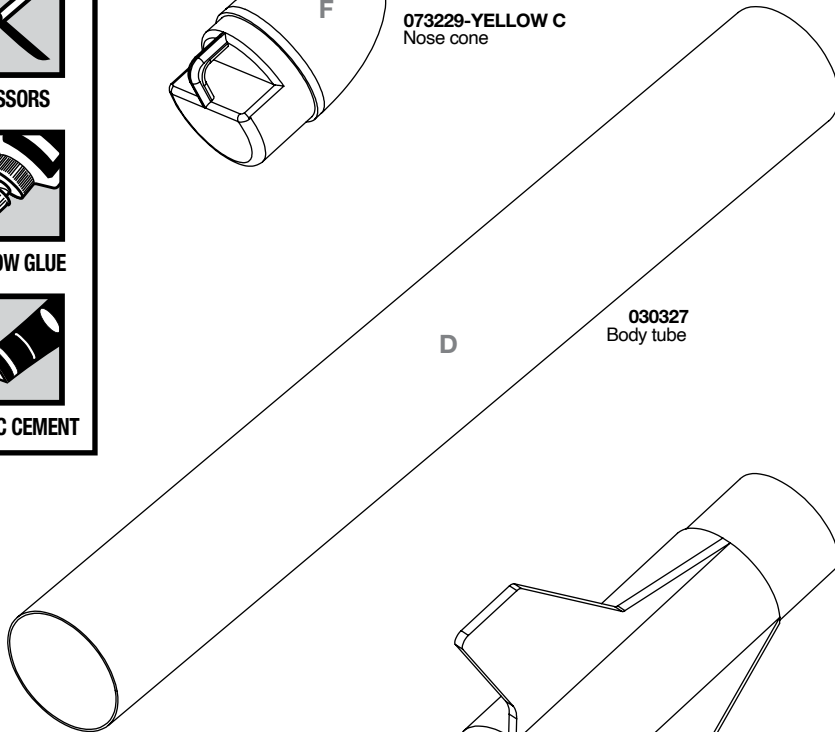

**030327**  
Body tube

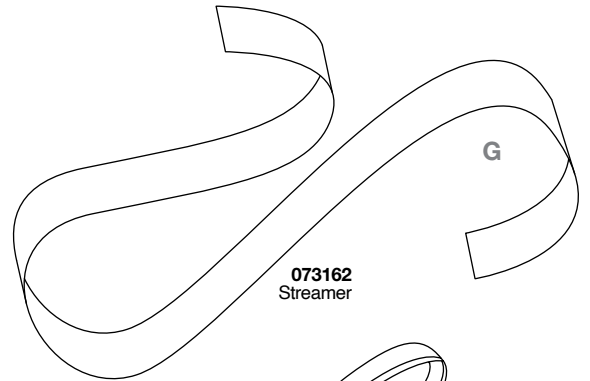

**073162**  
Streamer

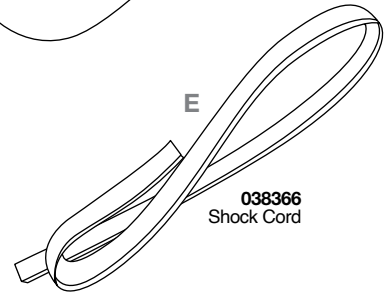

**038366**  
Shock Cord

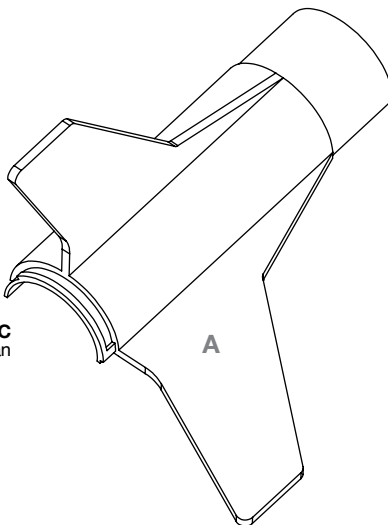

**066673-021C**  
Fin can

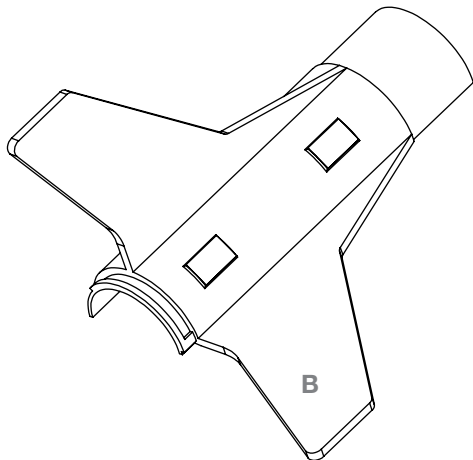

**B**

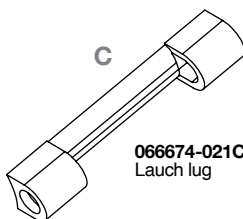

**066674-021C**  
Launch lug



**066675-021C**  
Engine cap

**090001-1738**  
Self-stick decal sheet



© 2025 Estes Industries, LLC. All Rights Reserved.  
Made in Guangzhou, Guangdong, China. PN 090001-1738 (11-25)

BACK OF SHOCK  
CORD ANCHOR

## ASSEMBLE FIN CAN

1. Apply a small amount of plastic cement to all alignment holes and pegs on part A.

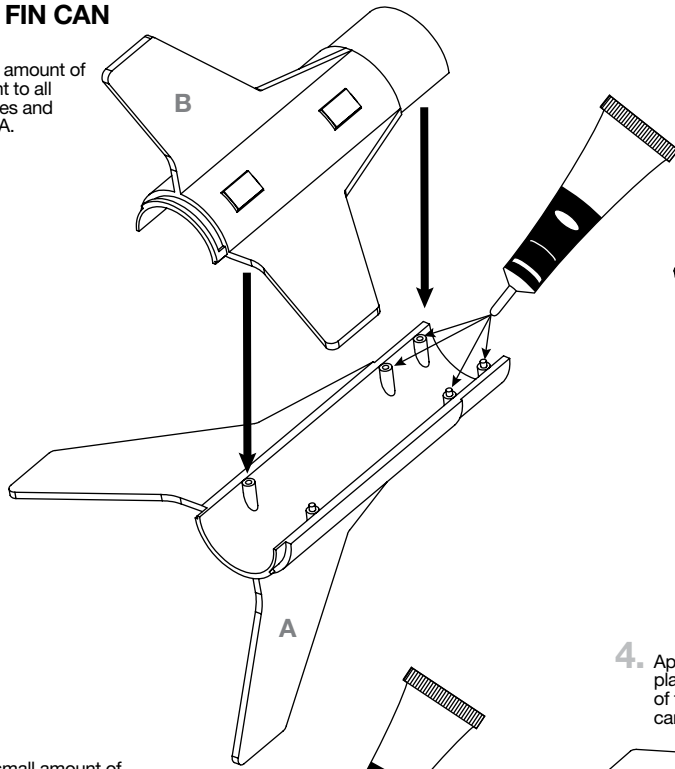

2. Press the two halves of the fin can together. Hold until set.

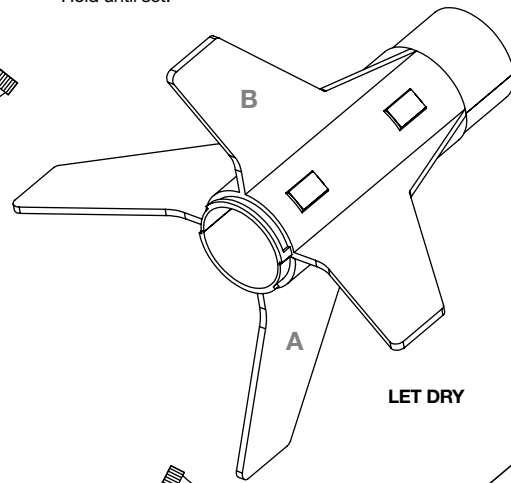

3. Apply a small amount of plastic cement to the square faces on the fin can. Place launch lug C onto glued surfaces.

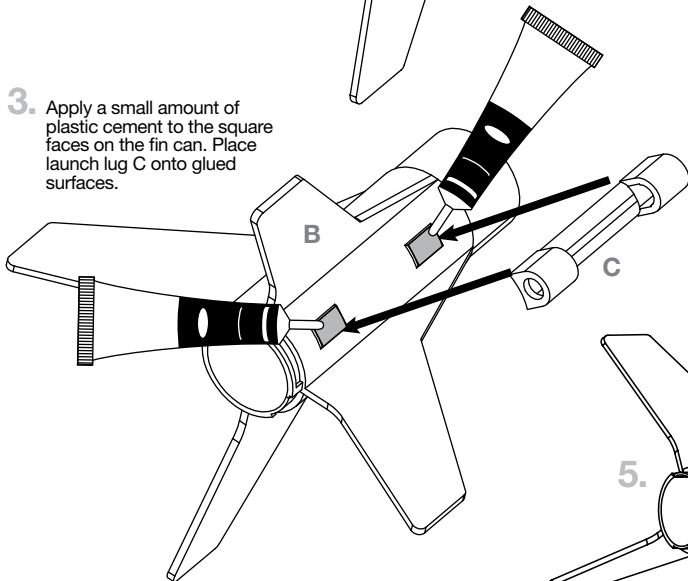

4. Apply a small amount of plastic cement to the top of the fin can. Insert fin can into body tube D.

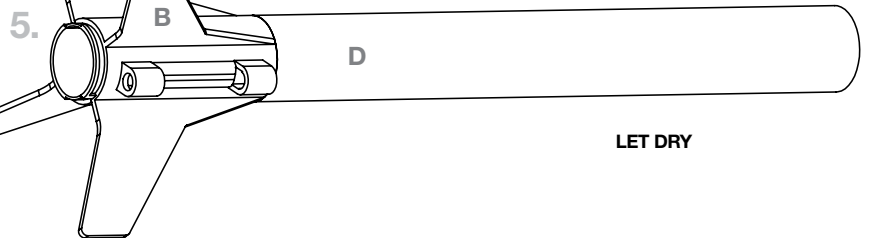
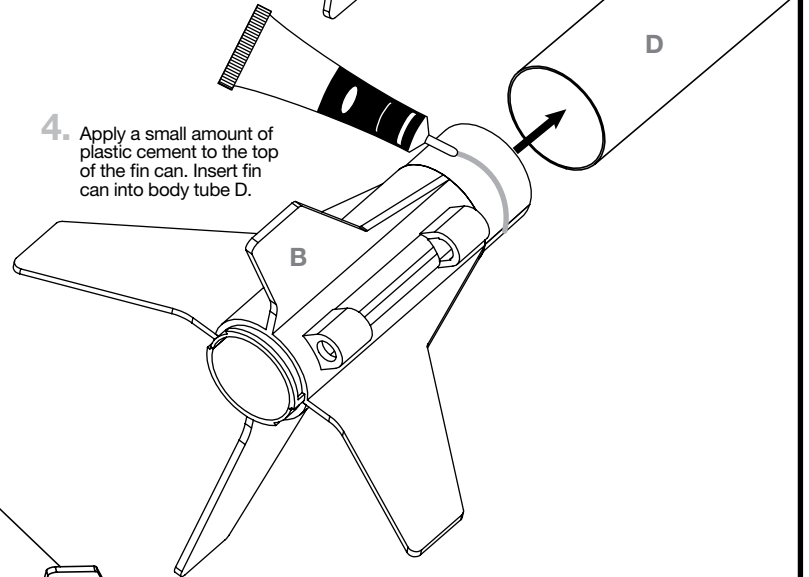

## INSTALL RECOVERY SYSTEM

1. Cut out this shock cord anchor.

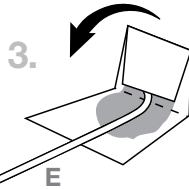
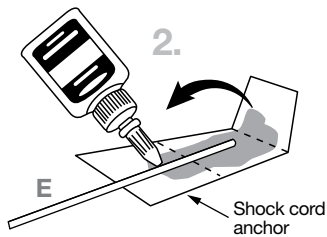
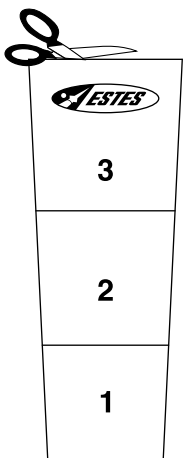

4. Hold until set.

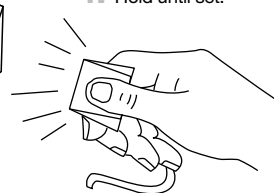

5. Apply glue to shock cord anchor and insert into body tube 1/2 in. (1.3 cm) from the end. Hold until set.

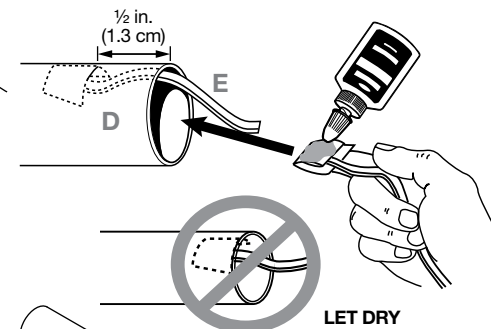

6. Tie other end of shock cord to nose cone.

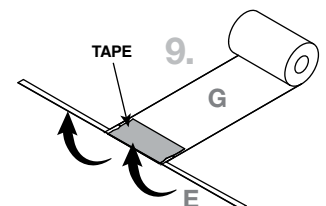
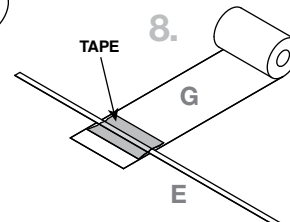
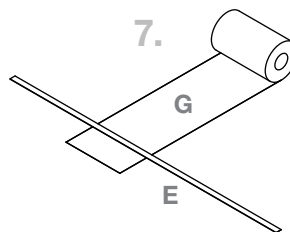
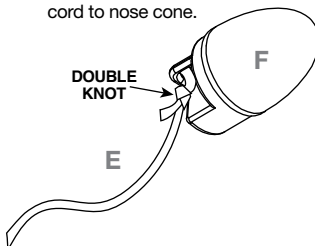

## PLACE DECALS



### NOTE:

Please refer to packaging for suggested paint scheme and/or decal placement.

## PREPARE RECOVERY SYSTEM

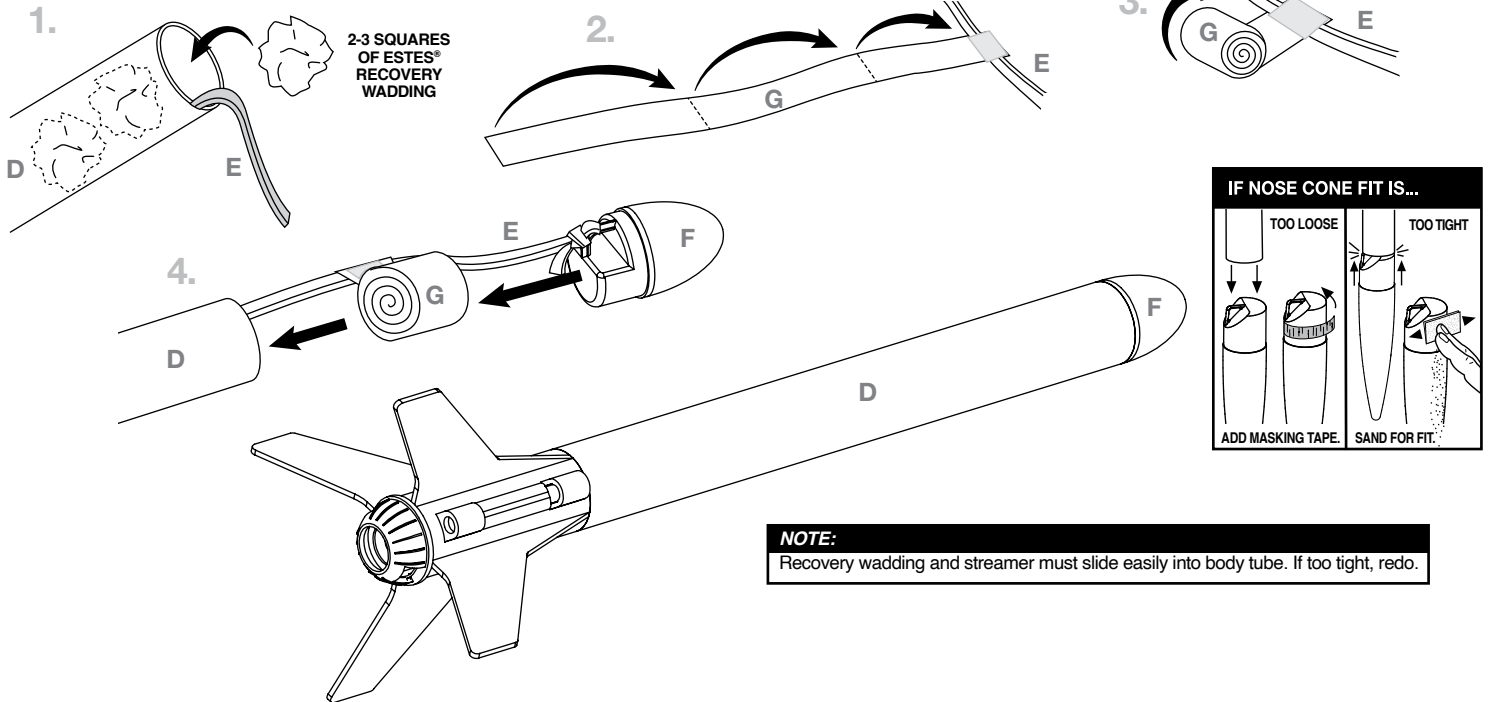

**NOTE:**  
Recovery wadding and streamer must slide easily into body tube. If too tight, redo.

## PREPARE ENGINE

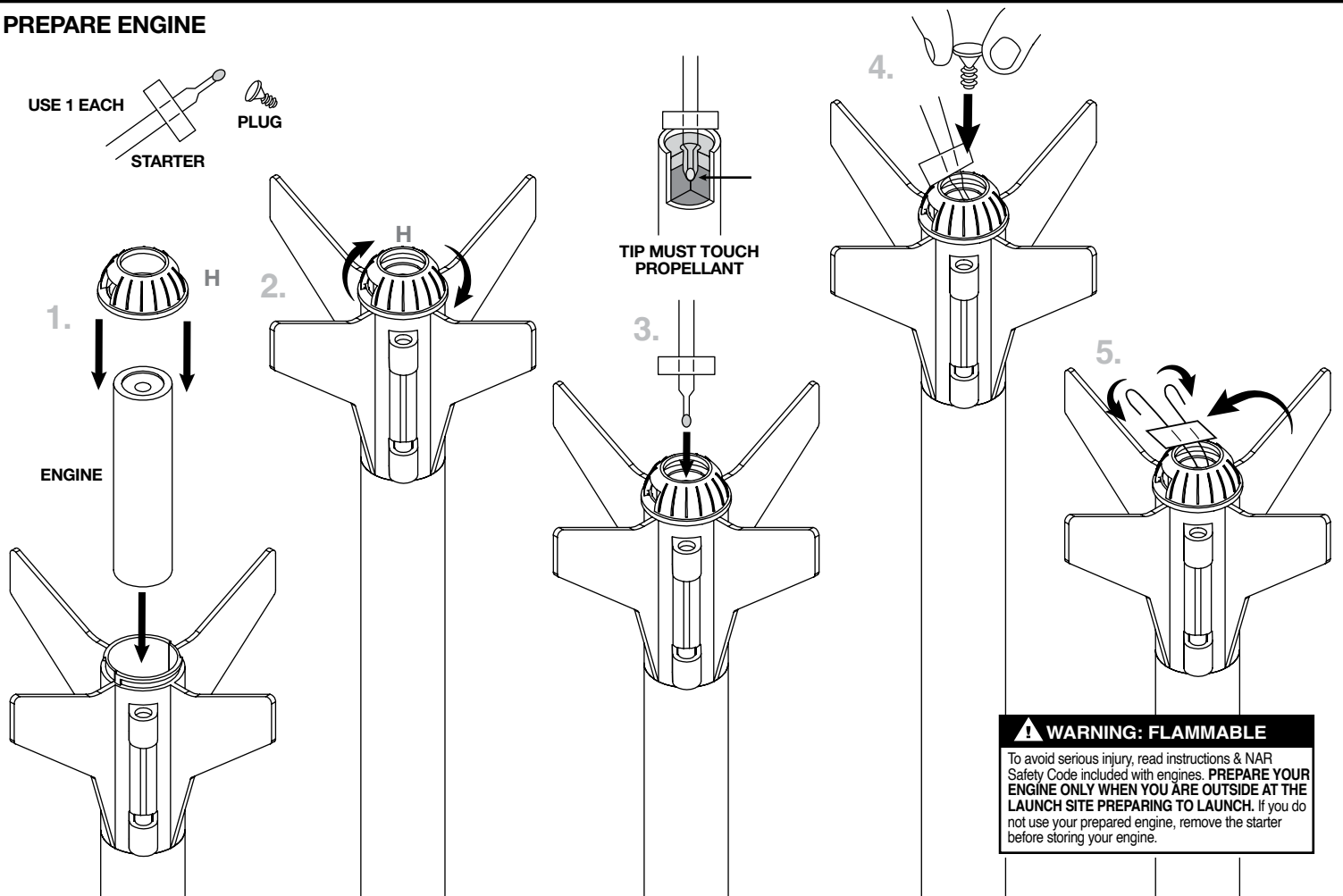

# COUNTDOWN AND LAUNCH

**NOTE:**  
Always keep the key **OUT** until final countdown.

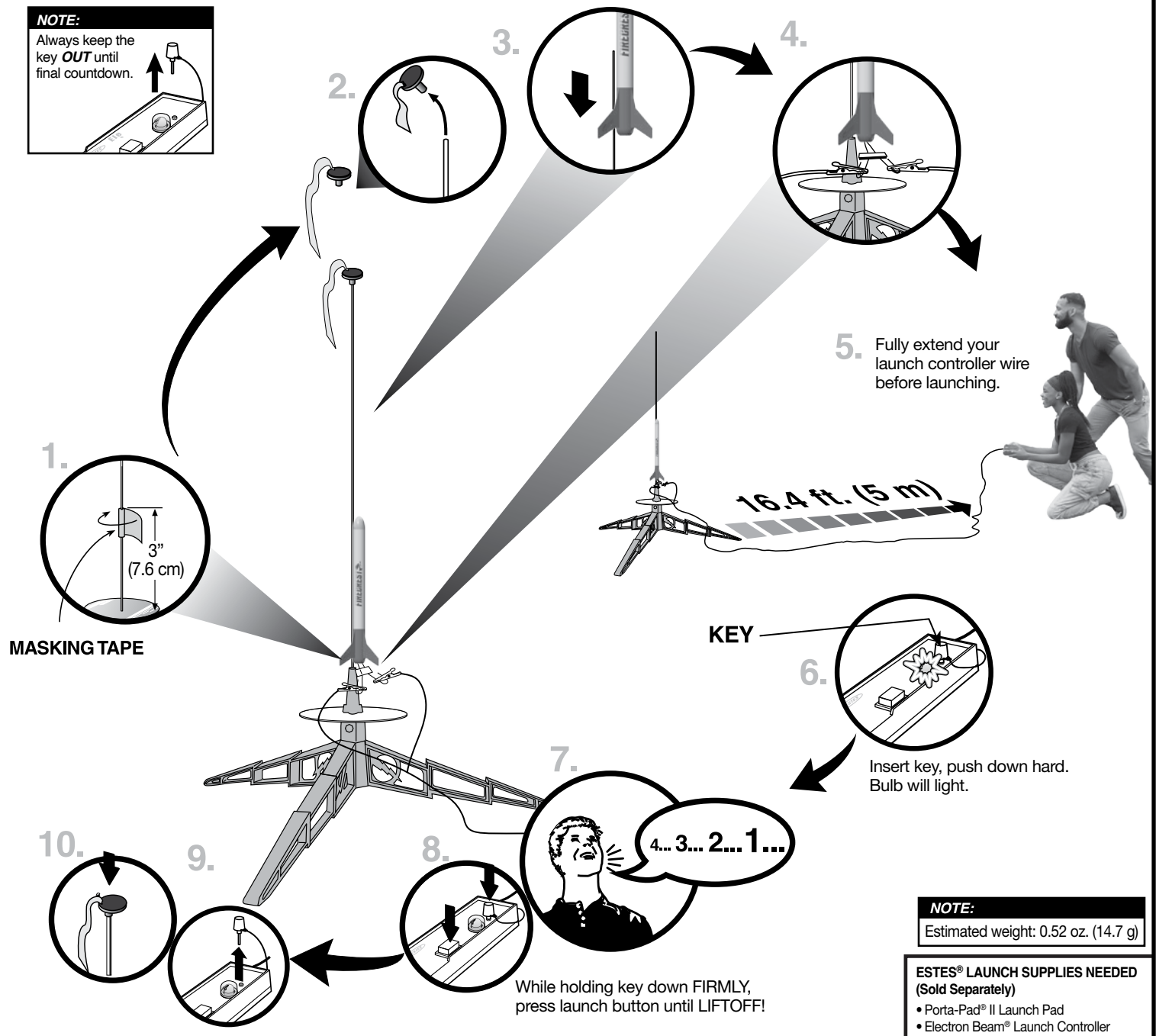

**NOTE:**  
Estimated weight: 0.52 oz. (14.7 g)

**ESTES® LAUNCH SUPPLIES NEEDED (Sold Separately)**

- Porta-Pad® II Launch Pad
- Electron Beam® Launch Controller
- Recovery Wadding
- Starters (with engines)
- Plugs (with engines)
- Estes® Engines: ¼A3-3T

## PRECAUTIONS



NAR SAFETY CODE



NO DRY GRASS OR WEEDS

**PRE-LAUNCH CHECK** For safety, never launch a damaged rocket. Check the rocket's body, nose cone and fins. Also, check the engine mount, recovery system and launch lug(s). Repair any damage before launching the rocket.

**FLYING YOUR ROCKET** Choose a large field (500 ft. [152 m] square) free of dry weeds and brown grass. The larger the launch area, the better your chance of recovering your rocket. Launch only with little or no wind and good visibility. Always follow the National Association of Rocketry (NAR) SAFETY CODE (enclosed).

**MISFIRES TAKE THE KEY OUT OF THE CONTROLLER. WAIT ONE MINUTE BEFORE GOING NEAR THE ROCKET.** Disconnect the micro-clips and remove the engine. Take the plug and starter out of the engine. A burned starter means the starter tip was not touching engine propellant. Install a new starter; be sure the tip is touching propellant inside the engine. Push the plug in place. Repeat steps under Countdown and Launch.

