



EstesRockets.com

BANSHEE™

1303

AGES
10+



Skill Level

INTERMEDIATE

MODEL ROCKET INSTRUCTIONS

KEEP FOR FUTURE REFERENCE

IMPORTANT: Please record date found on decal and keep for future reference. _____

READ ALL INSTRUCTIONS. Make sure you have all parts and supplies. Test fit all parts before applying glue. Refer to your glue manufacturer's dry times during build.

SUPPLIES



SOFT LEAD
PENCIL



FINE
SANDPAPER



RULER



YELLOW GLUE



HOBBY KNIFE



PLASTIC GLUE



MASKING
TAPE



SCISSORS



WHITE
PRIMER



PAINT
(Listed on Pg. 3)



CLEAR COAT
(OPTIONAL)

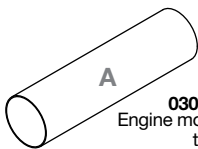

030408
Engine mount
tube

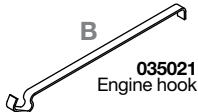

035021
Engine hook



030162-2
Engine block



030168
Retainer ring



080425
Green split
adapter ring



030164-2
Green adapter
ring



038176
Launch lugs **x2**



038362
Shock cord

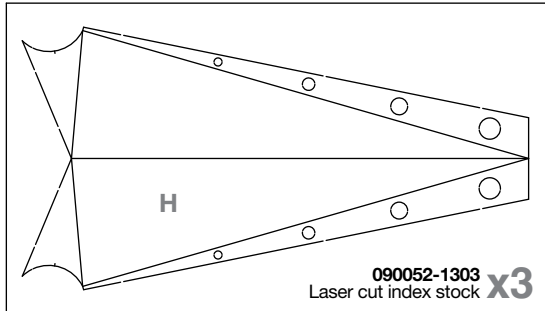

090052-1303
Laser cut index stock **x3**

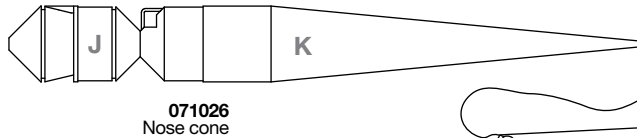

071026
Nose cone



090001-1303
Water slide decal

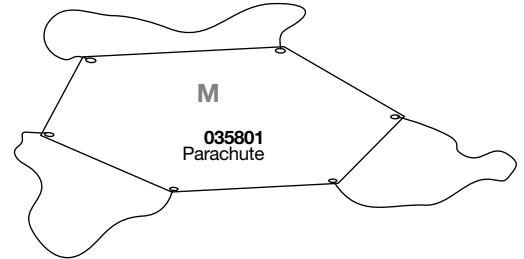

035801
Parachute



030352
Body tube

NOSE CONE AND NOZZLE PREPARATION

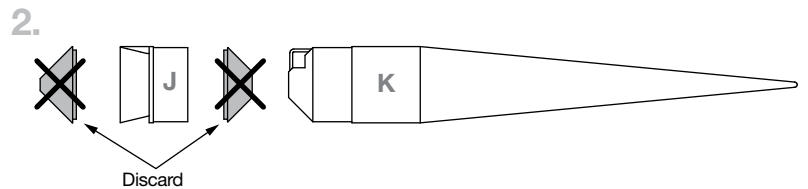
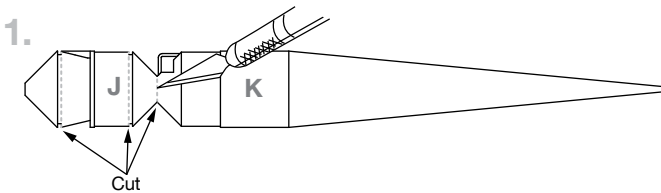

ASSEMBLE ENGINE MOUNT

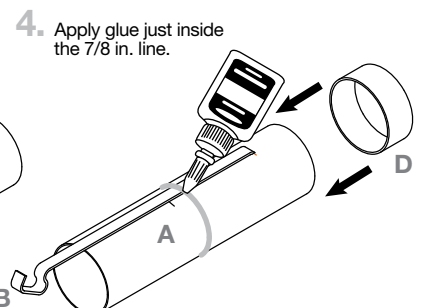
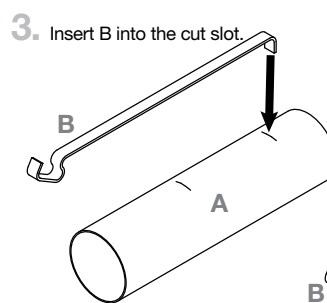
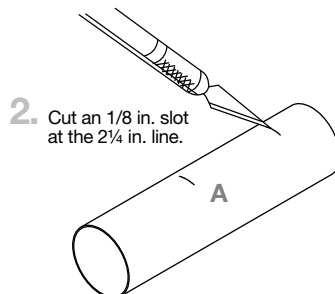
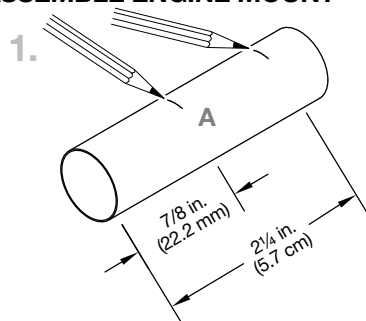

ASSEMBLE ENGINE MOUNT (CONTINUED)

- Slide D over A up to the 7/8 in. line. Apply glue on the opposite side of the 7/8 in. line.
 - Slide E over A up to the 7/8 in. line, flush with D. Apply glue to inside end of A.
 - Insert C into A until it rests against the inserted B tab. Apply glue to end of A.
 - LET DRY
- SIDE VIEW**
- 2 1/4 in. (5.7 cm)
- 7/8 in. (22.2 mm)
-

ASSEMBLE FINS

- Use a hobby knife with a new blade to cut along outside perimeter of fin. Cut out the 8 holes as well.
 - Fold up both outer sections.
 - Fold down both end sections.
 - Fold down both sides. Apply glue to left end section.
 - Align end sections, overlapping the right side over the left side. Hold together for 20 seconds to allow glue to set.
 - Apply a small bead of glue to the leading edge of the fin. Wipe away excess glue.
- LET DRY**
- x3**
-

MARK FIN LINES ON BODY TUBE

- Cut out this fin marking guide.
 - Wrap fin marking guide around body tube G. Secure with clear tape to keep in place.
 - Mark all FL lines on body tube G.
 - Remove the fin marking guide and use a door frame to extend all lines on the both body tubes.
- Clear tape
- DOOR FRAME
-

ATTACH FINS AND LAUNCH LUGS

1. Apply glue to the under side of the fin.

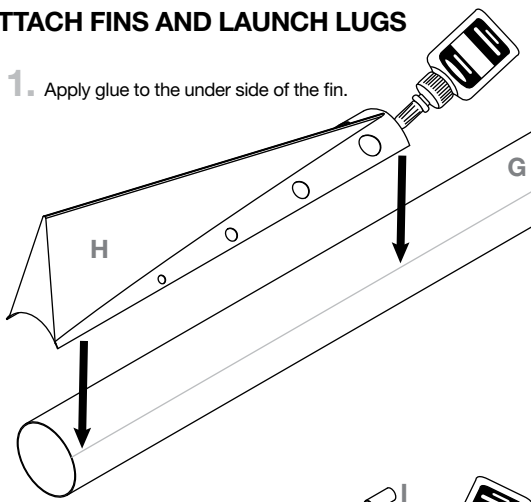

2. Place the fin on the body tube aligning the side with the "FL" line and align the bottom with the end of the body tube.

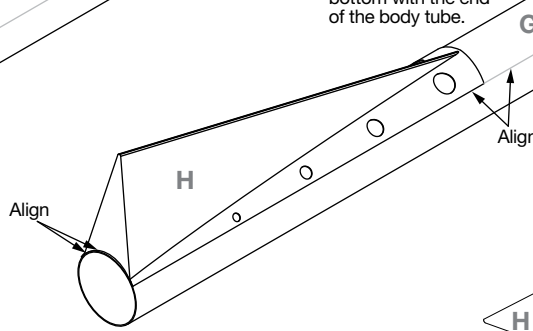

3.

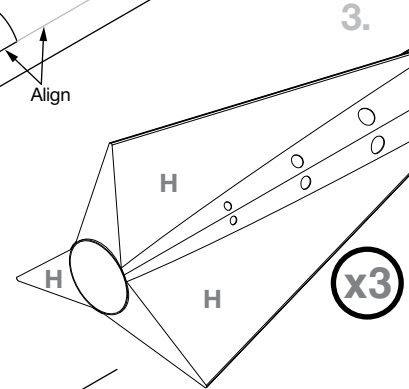

4. Apply glue as shown below.

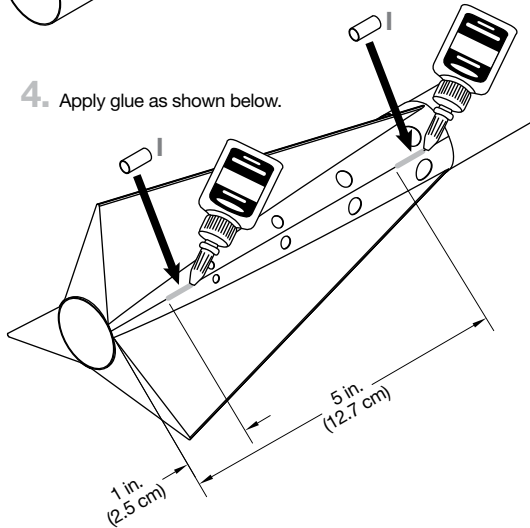

5. Place launch lugs I onto glued areas.

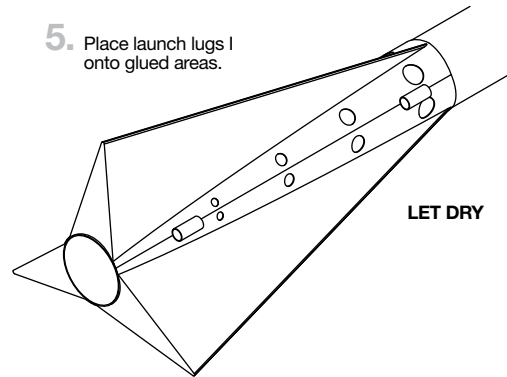

LET DRY

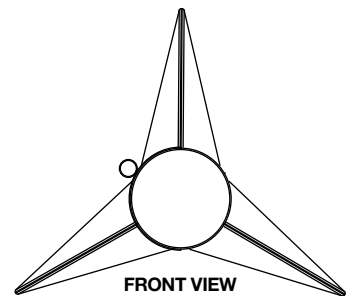

INSTALL ENGINE MOUNT

1. Apply glue as shown below.

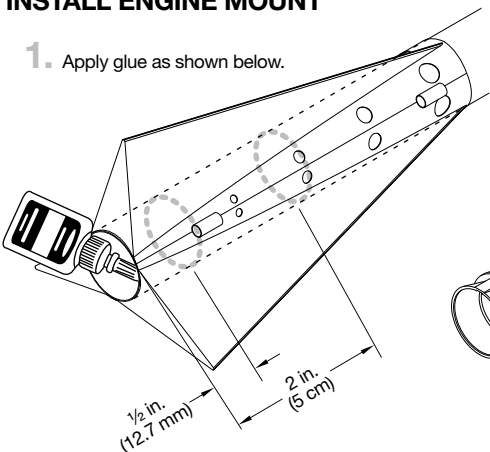

2. Insert engine mount. Insert nozzle J to set the distance.

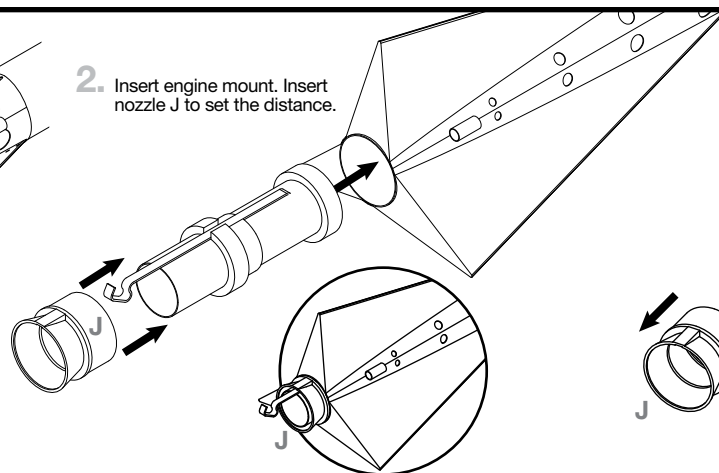

3. Remove J.

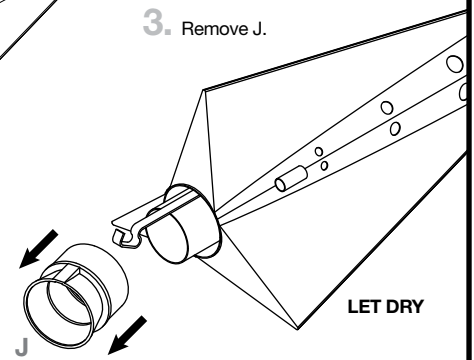

LET DRY

PAINT AND DECALS

PAINT COLORS: Black paint, red paint, and white paint

1. Spray rocket with white primer, let dry, and sand. Repeat until rocket is smooth.
2. Paint entire rocket white.
3. Mask off rocket as needed for red and black paint application.
4. Apply decals only after paint is dry.
5. Cut decals from sheet, trimming close to edge.
6. One at a time, place in warm water until decal curls and begins to relax.
7. Remove and position on rocket, sliding decal away from backing material.
8. Blot with clean paper towel. Let set overnight.
9. OPTIONAL: Apply protective clear coat.

Paint nozzle J separately. Paint black.

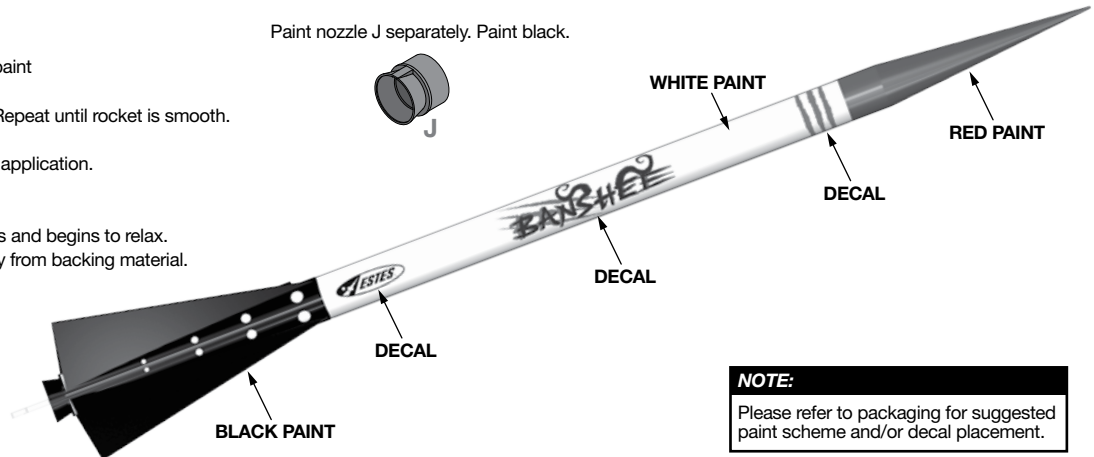

CAUTION:

For safe handling of spray paints, see manufacturer's warnings and follow instructions for use.

NOTE:

Please refer to packaging for suggested paint scheme and/or decal placement.

ATTACH NOZZLE

1. Apply plastic glue to the inside edge of body tube G.

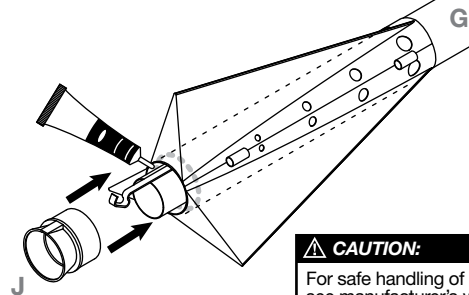

CAUTION:

For safe handling of plastic glue, see manufacturer's warnings and follow instructions for use.

2. Insert nozzle J into body tube.

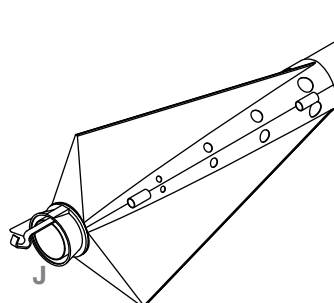

LET DRY

ASSEMBLE RECOVERY SYSTEM

1. Cut out this shock cord anchor.

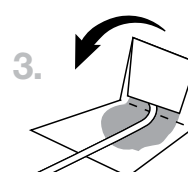
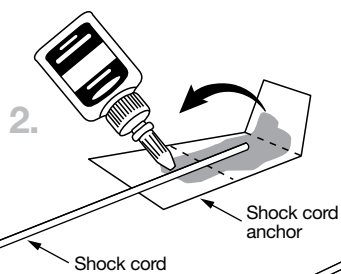
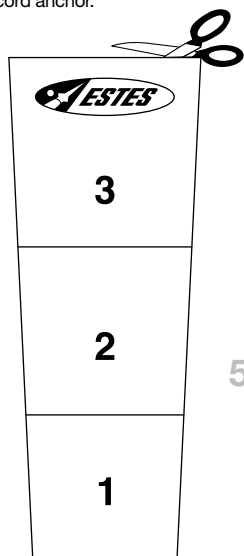

4. Hold until set.

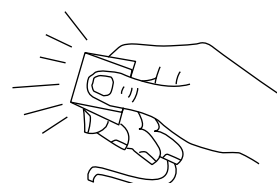

5. Apply glue to shock cord anchor and insert into body tube G 2 in. (5 cm) from the end. Hold until set.

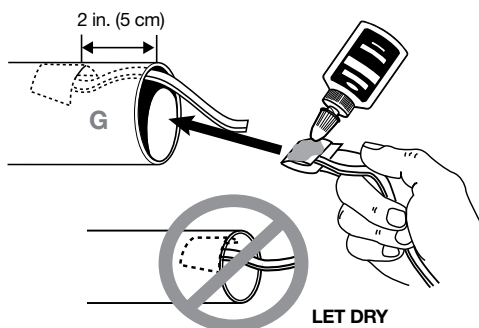

- 6.

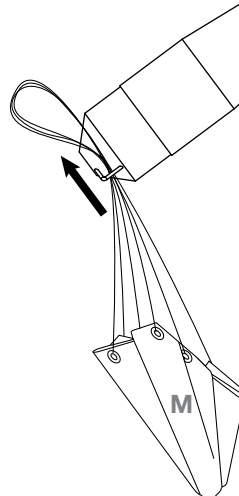

- 7.

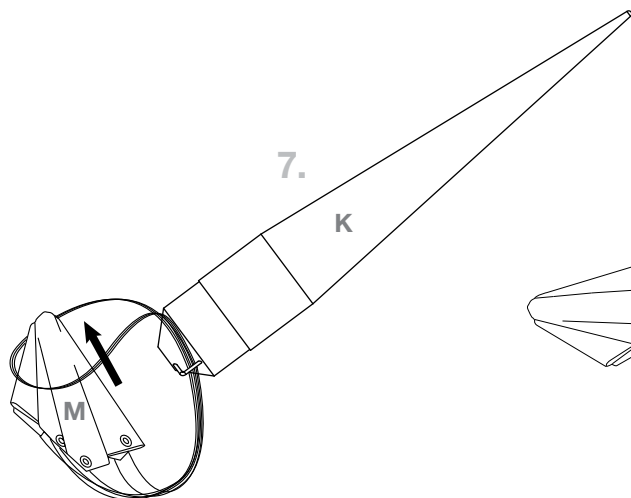

- 8.

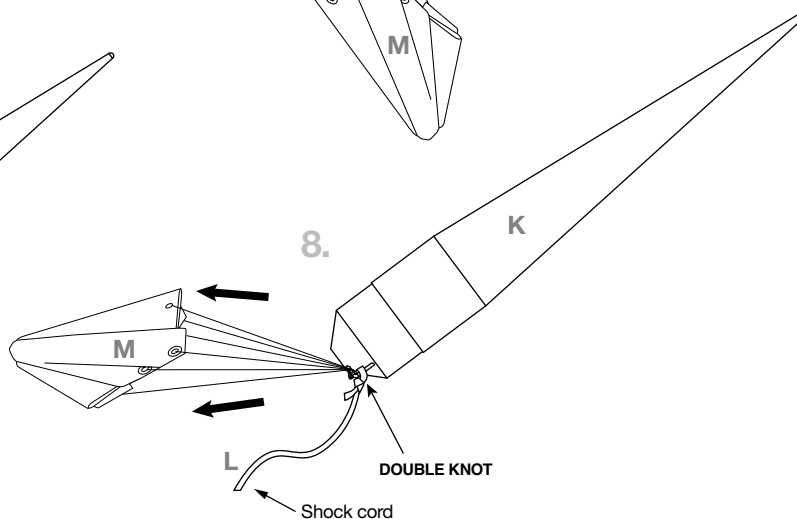

PREPARE RECOVERY SYSTEM

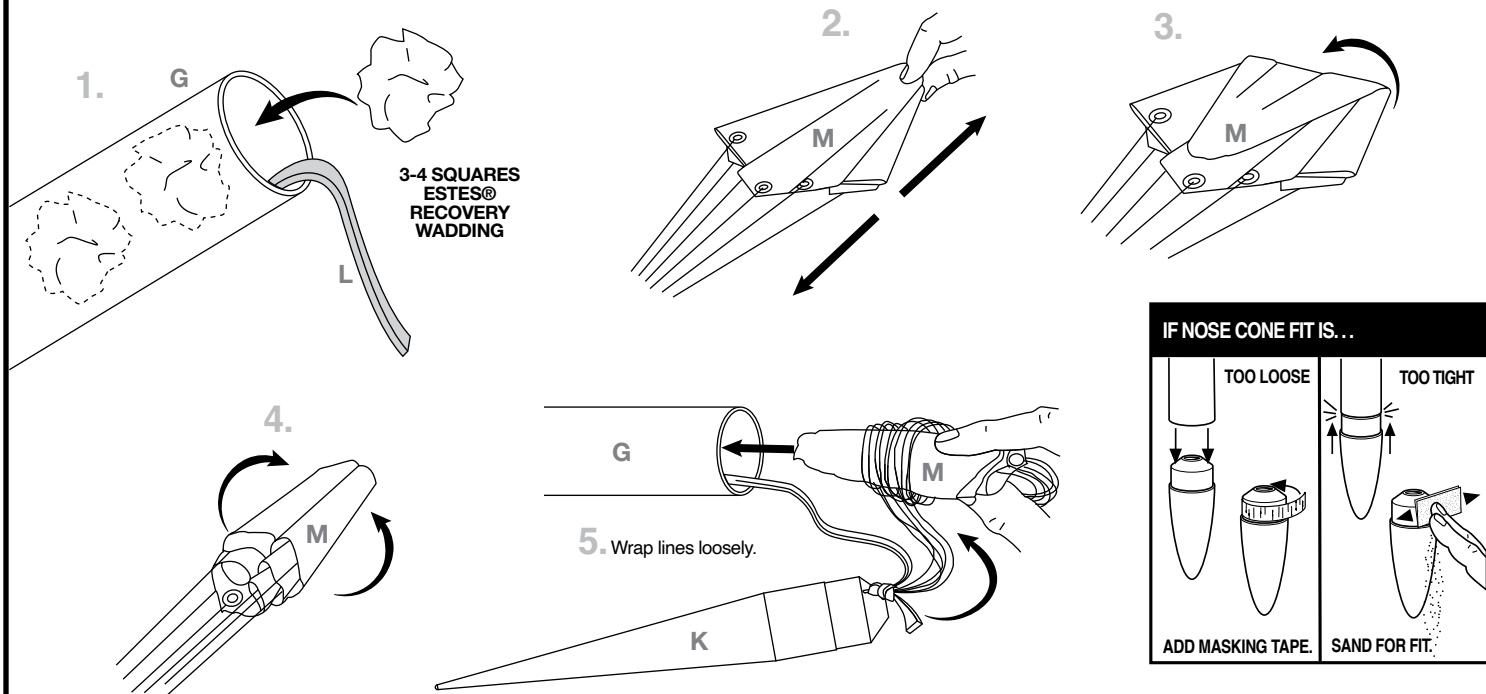

NOTE:

Recovery wadding and parachute must slide easily into body tube. If too tight, redo.

PREPARE ENGINE

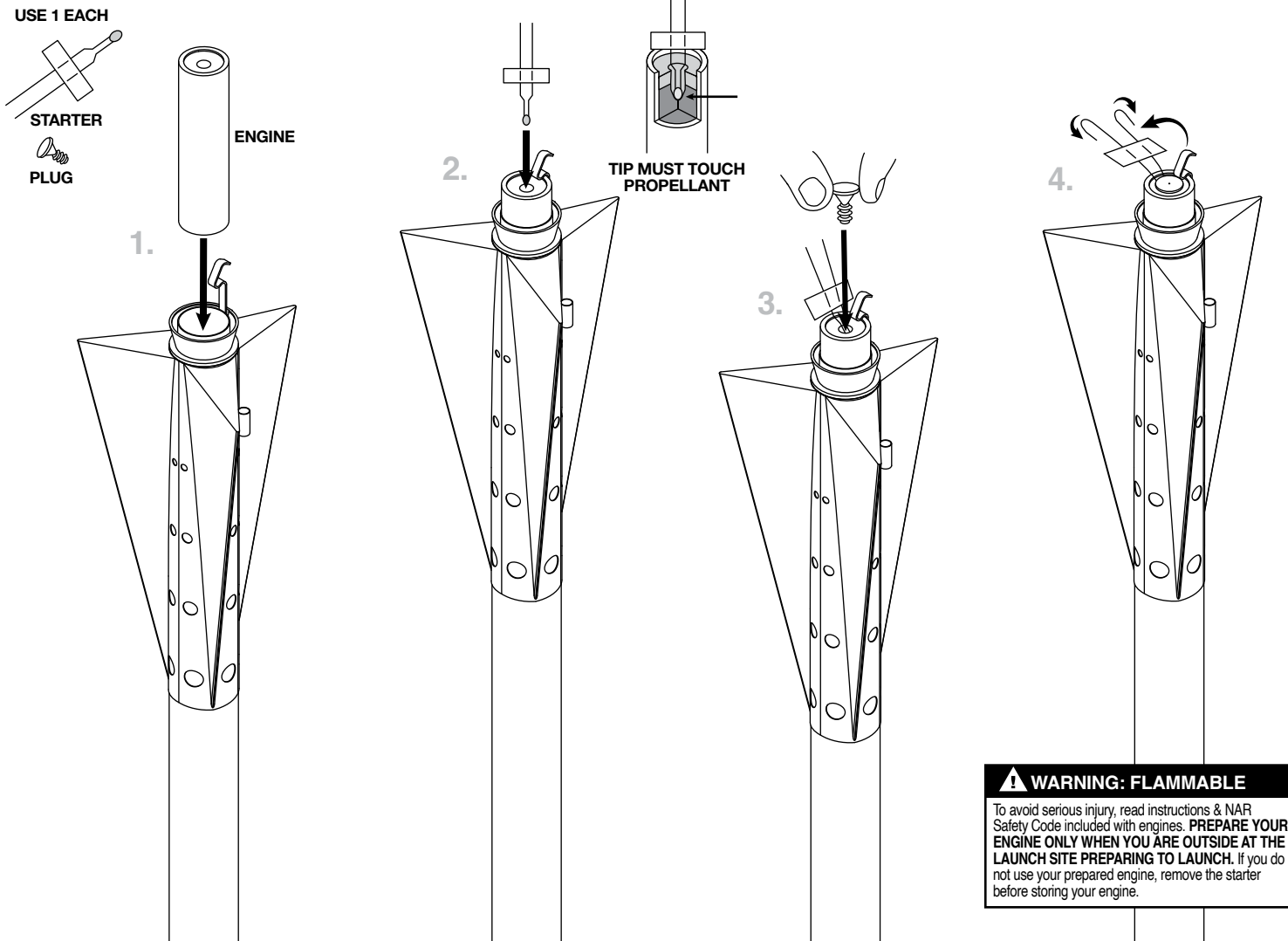

COUNTDOWN AND LAUNCH

NOTE:

Always keep the key **OUT** until final countdown.

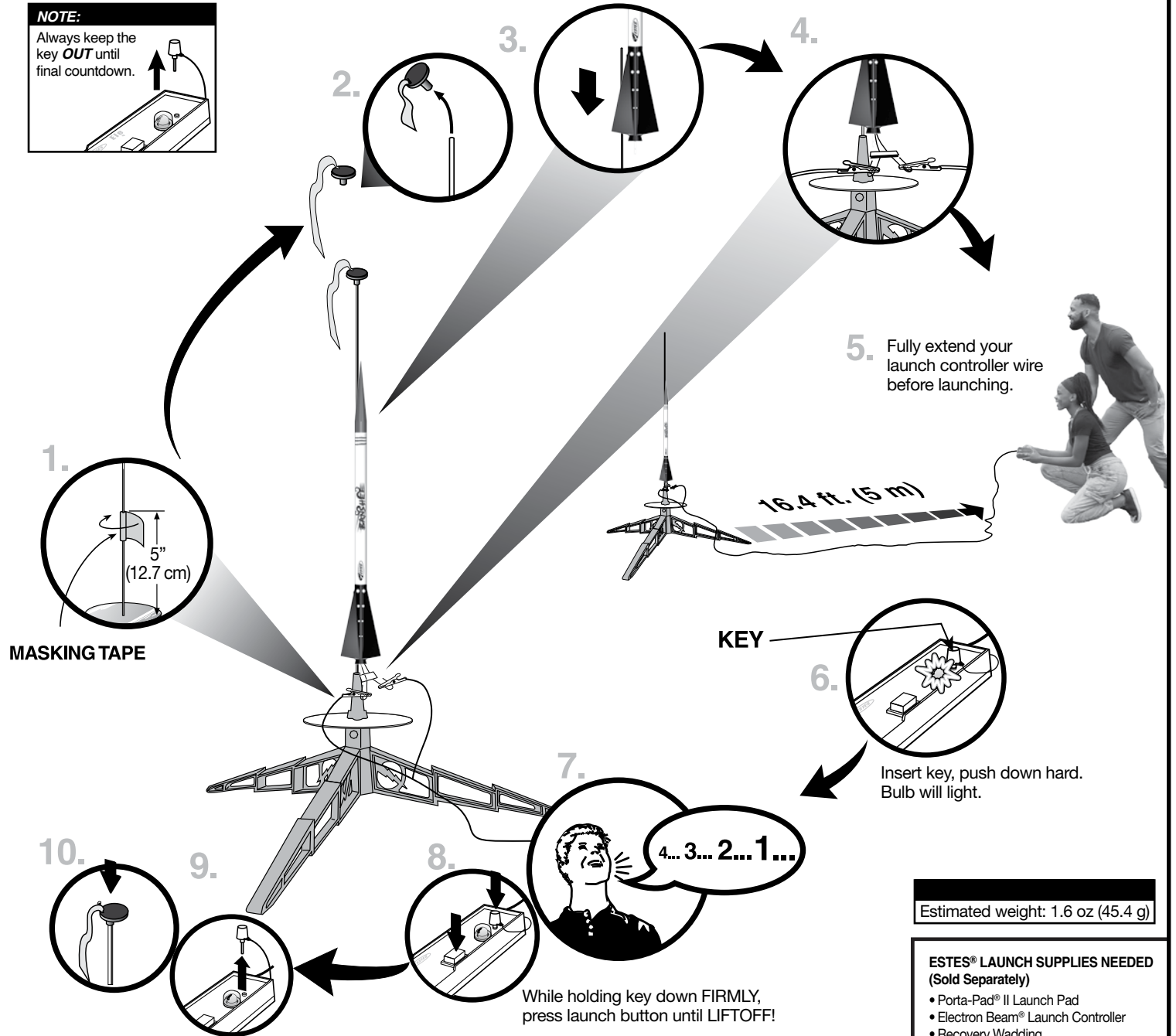

Estimated weight: 1.6 oz (45.4 g)

ESTES® LAUNCH SUPPLIES NEEDED (Sold Separately)

- Porta-Pad® II Launch Pad
- Electron Beam® Launch Controller
- Recovery Wadding
- Starters (with engines)
- Plugs (with engines)
- Estes® Engines: B4-4, B6-4, C6-5

PRECAUTIONS



NAR SAFETY CODE



NO DRY GRASS OR WEEDS

PRE-LAUNCH CHECK For safety, never launch a damaged rocket. Check the rocket's body, nose cone and fins. Also, check the engine mount, recovery system and launch lug(s). Repair any damage before launching the rocket.

FLYING YOUR ROCKET Choose a large field (1000 ft. [305 m] square) free of dry weeds and brown grass. The larger the launch area, the better your chance of recovering your rocket. Launch only with little or no wind and good visibility. Always follow the National Association of Rocketry (NAR) SAFETY CODE (enclosed).

MISFIRES TAKE THE KEY OUT OF THE CONTROLLER. WAIT ONE MINUTE BEFORE GOING NEAR THE ROCKET. Disconnect the micro-clips and remove the engine. Take the plug and starter out of the engine. A burned starter means the starter tip was not touching engine propellant. Install a new starter; be sure the tip is touching propellant inside the engine. Push the plug in place. Repeat steps under Countdown and Launch.