



ESTES INDUSTRIES
1295 H STREET
Penrose, CO 81240
The World Leader in
Model Rocketry

ASTROCAM[®]

(8-97) 8411.
EST 1813

READY-BUILT™ FLYING MODEL ROCKET INSTRUCTIONS

1. PARACHUTE ATTACHMENT

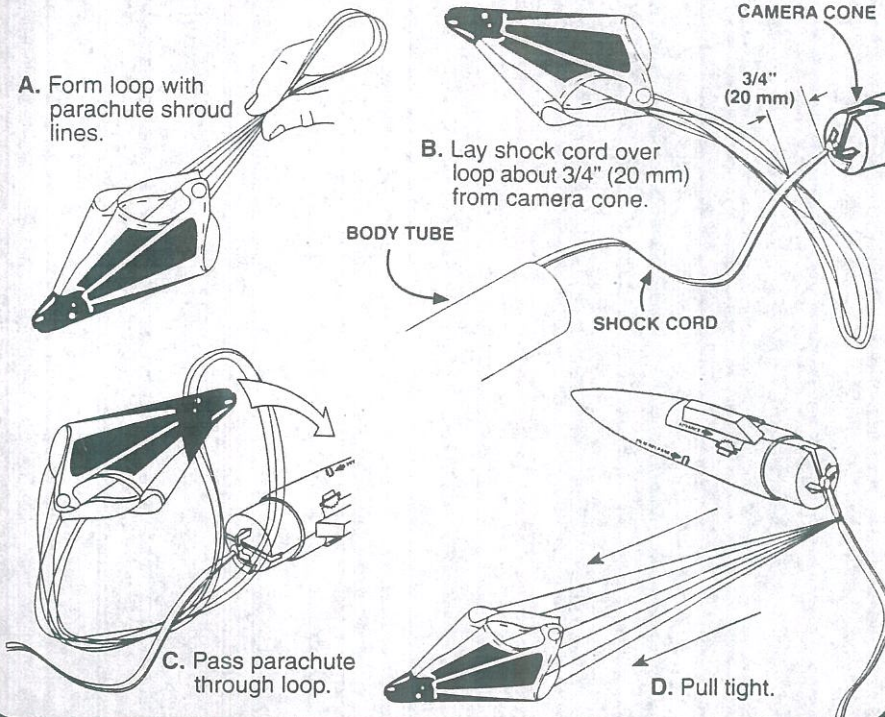

2. PREPARING THE PARACHUTE

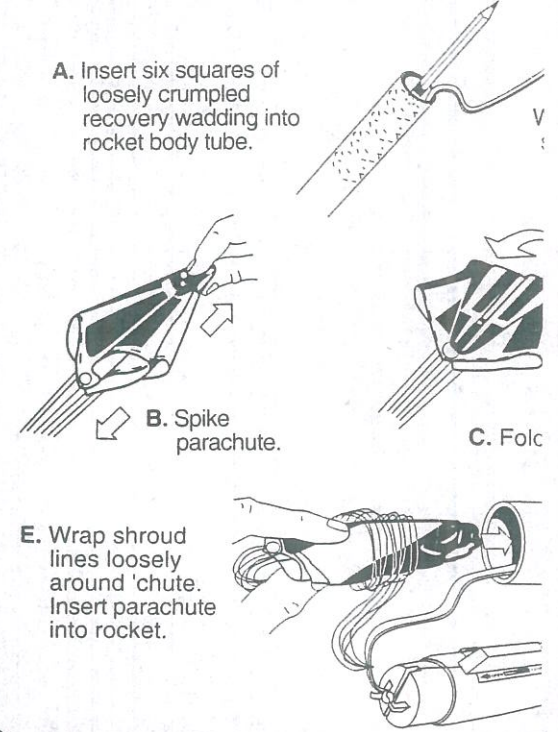

4. CAMERA OPERATION

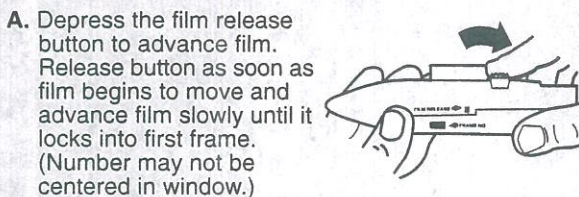

NOTE: Do not attempt to overwind or wind too fast as this may damage the camera.

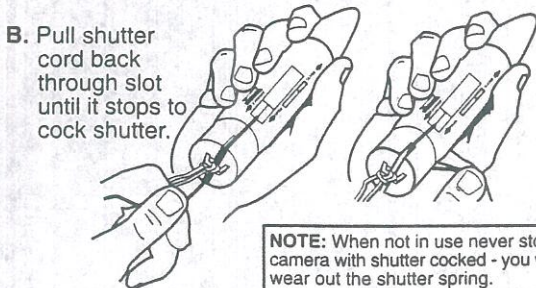

NOTE: When not in use never store camera with shutter cocked - you will wear out the shutter spring.

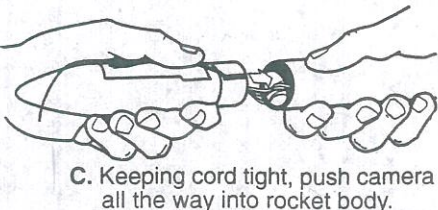

5. PREPARING THE ENGINE FOR FLIGHT

WARNING: FLAMMABLE
Before proceeding read the NAR Safety Code and instructions included with engines. Prepare your engine **ONLY** when you are at the launch site preparing to launch! If you do not use your prepared engine, remove the igniter before storing your engine.

