

# ESTES AGM-86™ CRUISE MISSILE

www.estesrockets.com  
 ESTES INDUSTRIES  
 1295 H Street  
 Penrose, CO 81240  
 PRINTED IN CHINA

**FLYING MODEL ROCKET KIT INSTRUCTIONS**  
 KEEP FOR FUTURE REFERENCE



**OPERATION SEARCH & DESTROY #1886**

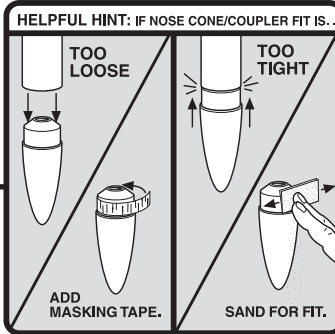

## 1. ATTACH PARACHUTE

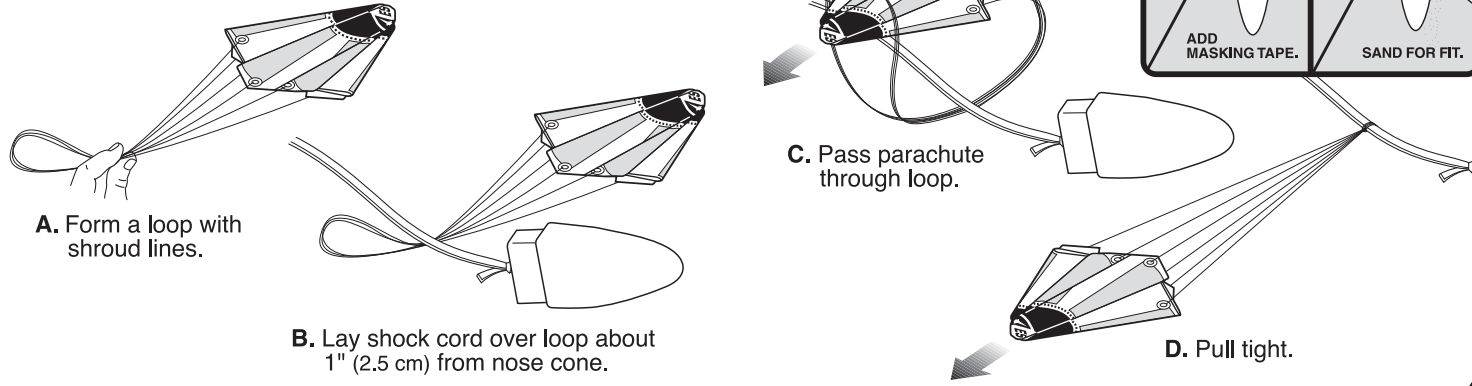

## 2. PREPARE PARACHUTE FOR FLIGHT

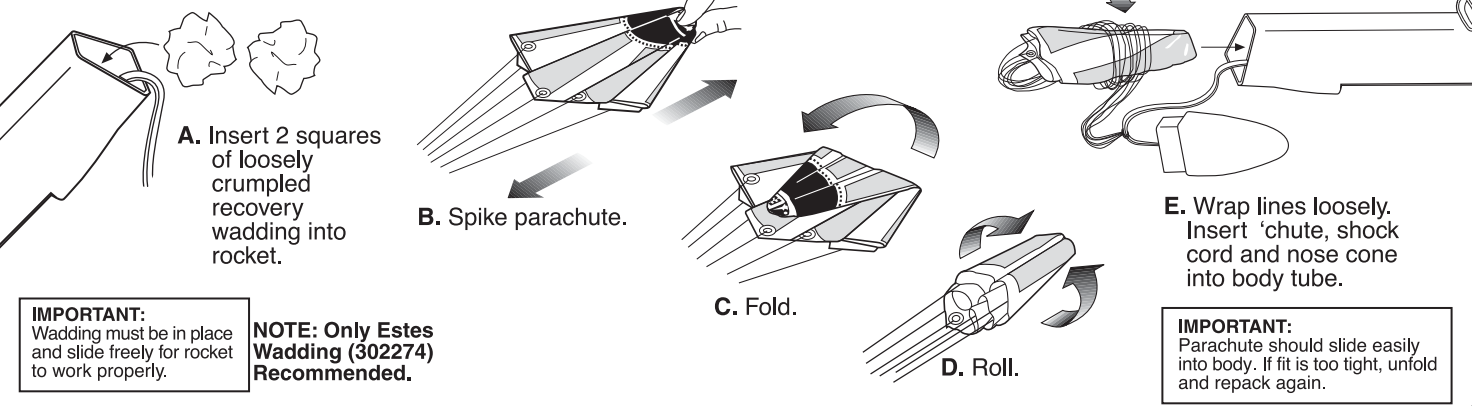

## PREPARE ENGINE

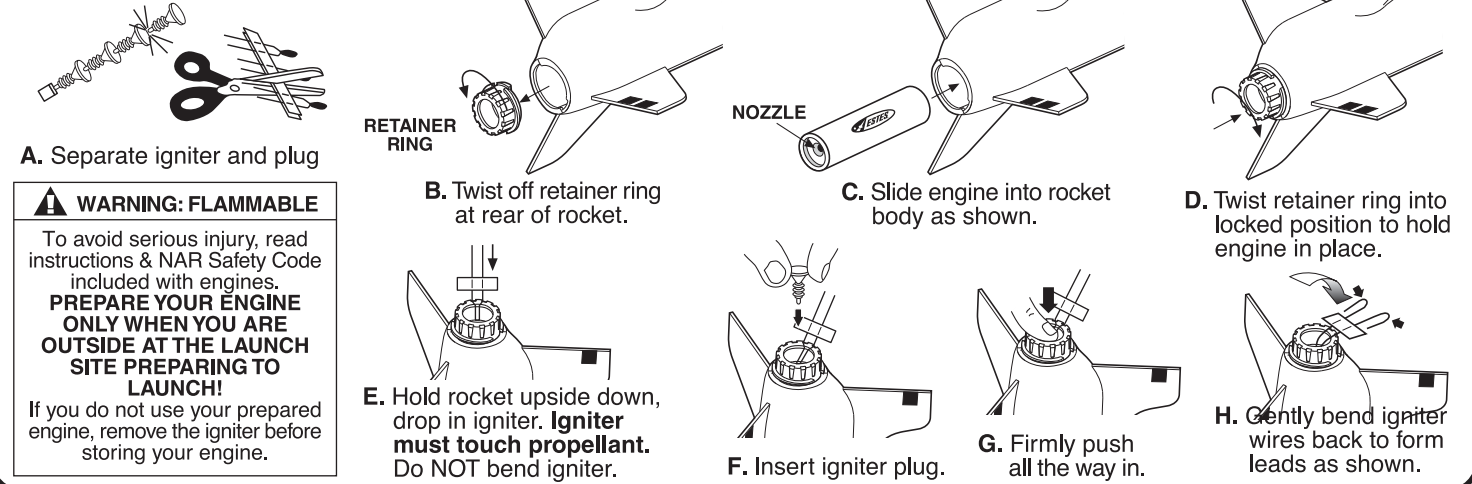

## COUNTDOWN AND LAUNCH

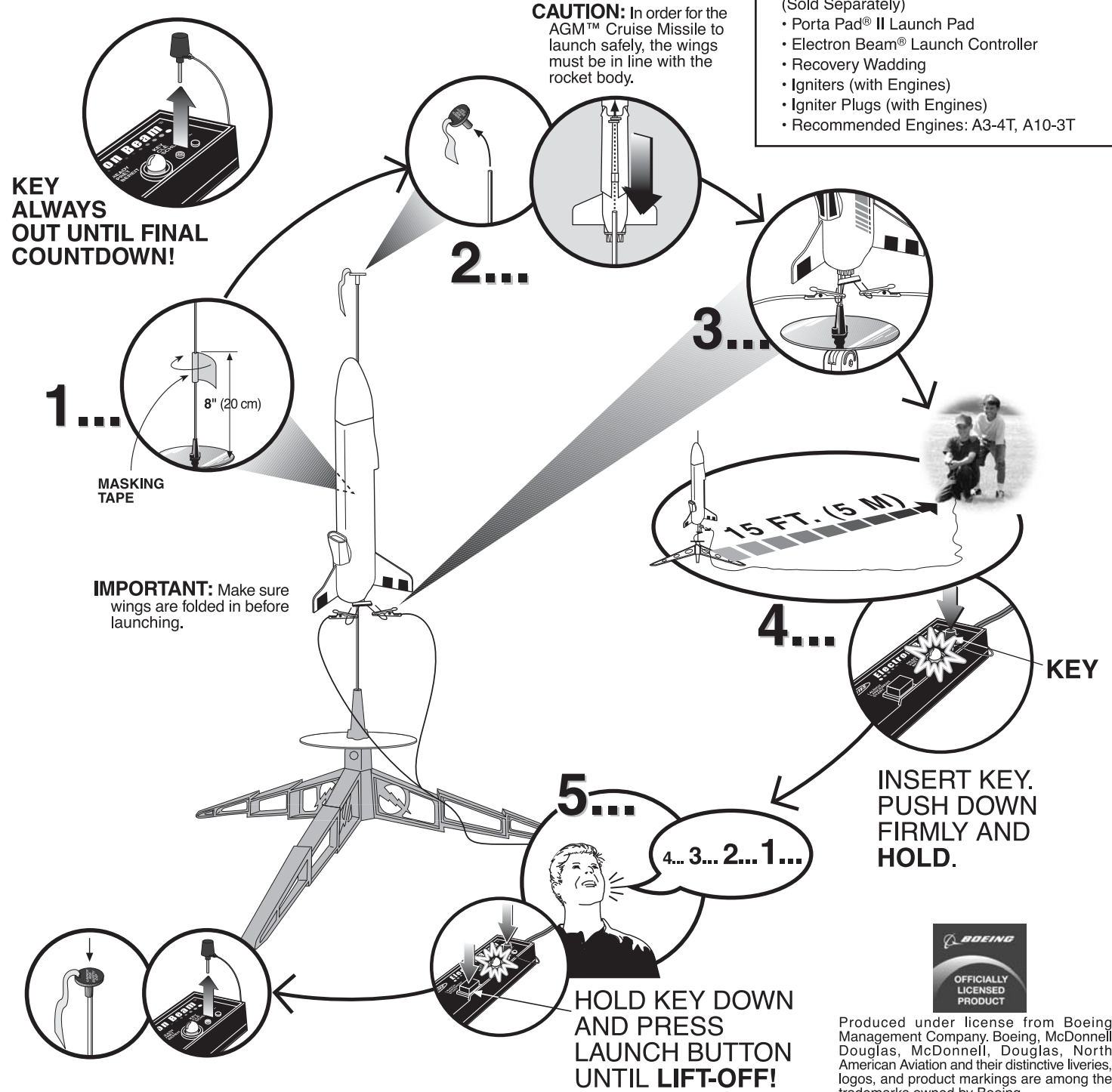

- ESTES LAUNCH SUPPLIES** (Sold Separately)
- Porta Pad® II Launch Pad
  - Electron Beam® Launch Controller
  - Recovery Wadding
  - Igniters (with Engines)
  - Igniter Plugs (with Engines)
  - Recommended Engines: A3-4T, A10-3T

## PRECAUTIONS



## FLYING YOUR ROCKET

Choose a large field (500 ft. [152 m] square) free of dry weeds and brown grass. The larger the launch area, the better your chance of recovering your rocket. Football fields and playgrounds are great. Launch only with little or no wind and good visibility. Always follow the National Association of Rocketry (BF) SAFETY CODE.

## MISFIRES

TAKE THE KEY OUT OF THE CONTROLLER. WAIT ONE MINUTE BEFORE GOING NEAR THE ROCKET! Disconnect the igniter clips. Take the plug and igniter out of the engine. If the igniter has burned, it worked but did not ignite the engine because it was not touching the propellant inside the engine. Put a new igniter all the way inside the engine without bending it. Push the plug in place. Repeat the steps under Countdown and Launch.



Produced under license from Boeing Management Company. Boeing, McDonnell Douglas, McDonnell, Douglas, North American Aviation and their distinctive liveries, logos, and product markings are among the trademarks owned by Boeing.