



www.estesrockets.com

ESTES INDUSTRIES
1295 H Street
Penrose CO 81240
PRINTED IN CHINA

SUPER SHOT™ RACE SET

MINI FLYING MODEL ROCKET INSTRUCTIONS

KEEP FOR FUTURE REFERENCE

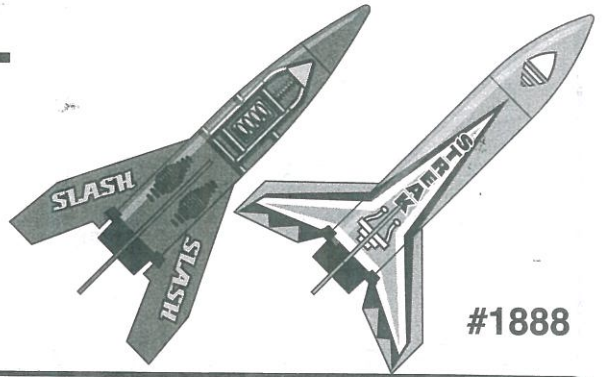

ASSEMBLY TIP: Read all instructions before beginning work on your model. Make sure you have all parts and supplies.

Use these instructions for each of your Super Shot™ rockets.

1. ATTACH STREAMER

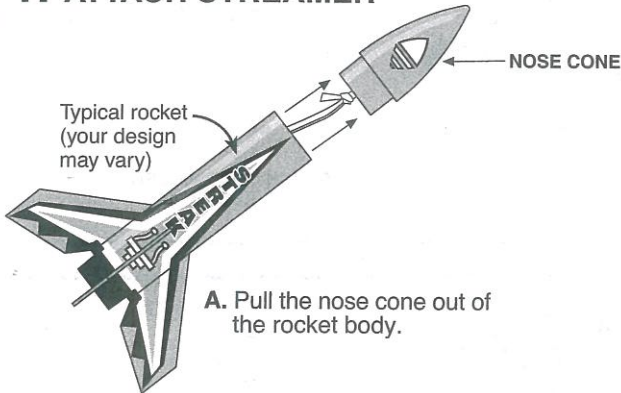

A. Pull the nose cone out of the rocket body.

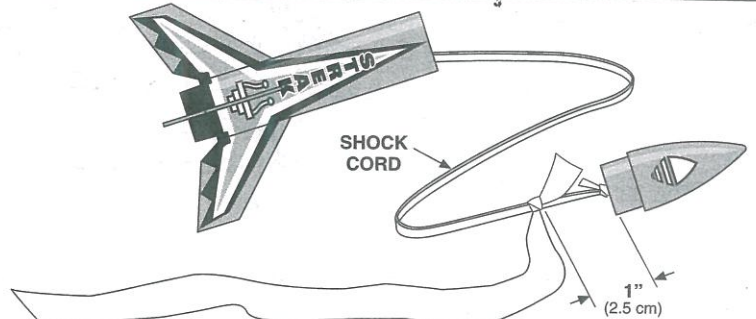

B. Measure 1" (2.5 cm) from the nose cone and tie streamer to shock cord with a double knot.

IMPORTANT: Do NOT attach a streamer to the "SLASH" rocket.

2. PREPARE STREAMER FOR FLIGHT

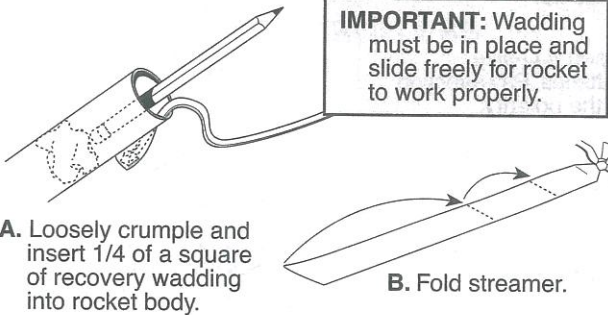

A. Loosely crumple and insert 1/4 of a square of recovery wadding into rocket body.

B. Fold streamer.

C. Roll.

D. Wrap shock cord loosely around streamer. Insert streamer into rocket. Streamer should slide easily into body tube. If fit is too tight, unfold and repack.

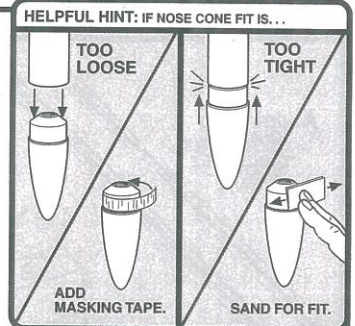

IMPORTANT: For "SLASH" rocket, insert wadding and shock cord into rocket body tube.

3. PREPARE ENGINE FOR FLIGHT

WARNING : FLAMMABLE
To avoid serious injury, read instructions & NAR Safety Code included with engines.
PREPARE YOUR ENGINE ONLY WHEN YOU ARE OUTSIDE AT THE LAUNCH SITE PREPARING TO LAUNCH!
If you do not use your prepared engine, remove the igniter before storing your engine.

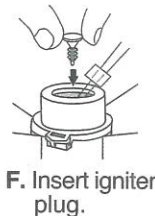
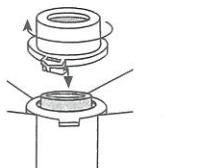
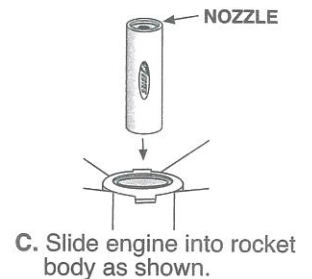
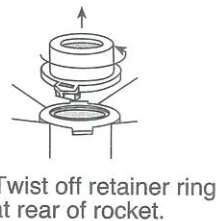

LAUNCH PAD (FOR MINI ENGINE ROCKETS ONLY)

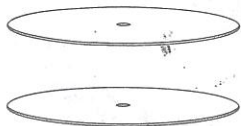

BLAST DEFLECTOR (2)
(60121)

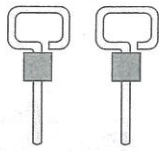

SAFETY KEY (2)
(38101)

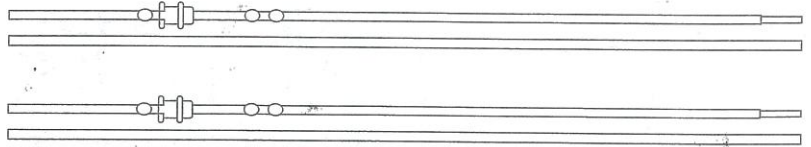

LAUNCH ROD
(2 pieces) (2 sets)
(60137)



SAFETY CAP (2)
(60139)



DUELING LAUNCH PAD (1)
(61222)

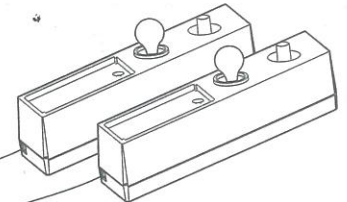

LAUNCH CONTROLLERS (2)
(61223)

SUPPLIES REQUIRED:



PHILLIPS SCREWDRIVER



SAND PAPER



MASKING TAPE

1. JOIN LAUNCH RODS

A. Join two pieces as shown.

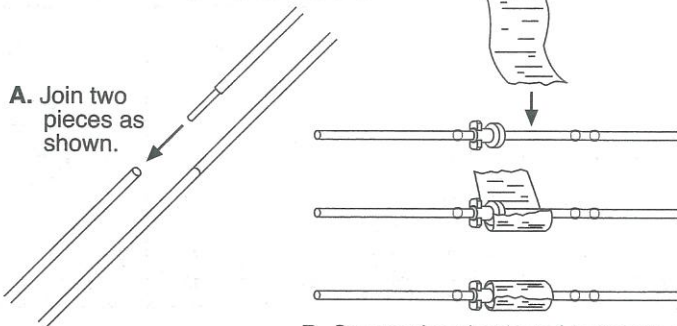

B. Secure the plastic rod lock with a piece of masking tape as shown to protect it during the next step.

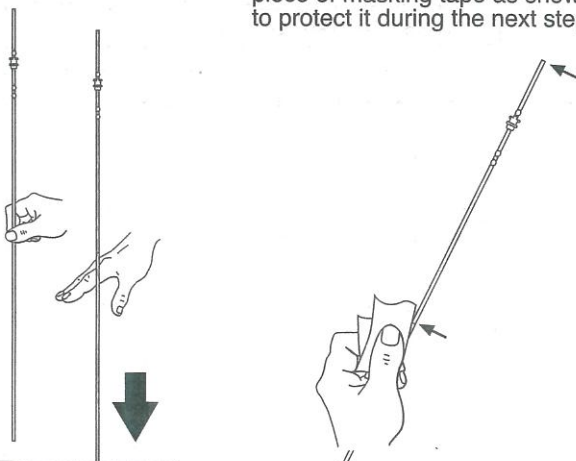

CONCRETE FLOOR

C. Drop rod repeatedly on concrete floor until joint is tight. Remove tape.

D. Sand the joint and both ends smooth with light grade sandpaper.

2. INSTALL BATTERIES

A. Lift latch and open race case.

B. Remove screws from top of battery compartment and lift off lid.

C. Insert 4 D-size batteries. Pay attention to the polarity. A "+" and "-" are marked on the bottom of each cavity.

D. Replace lid. Insert and tighten screws.

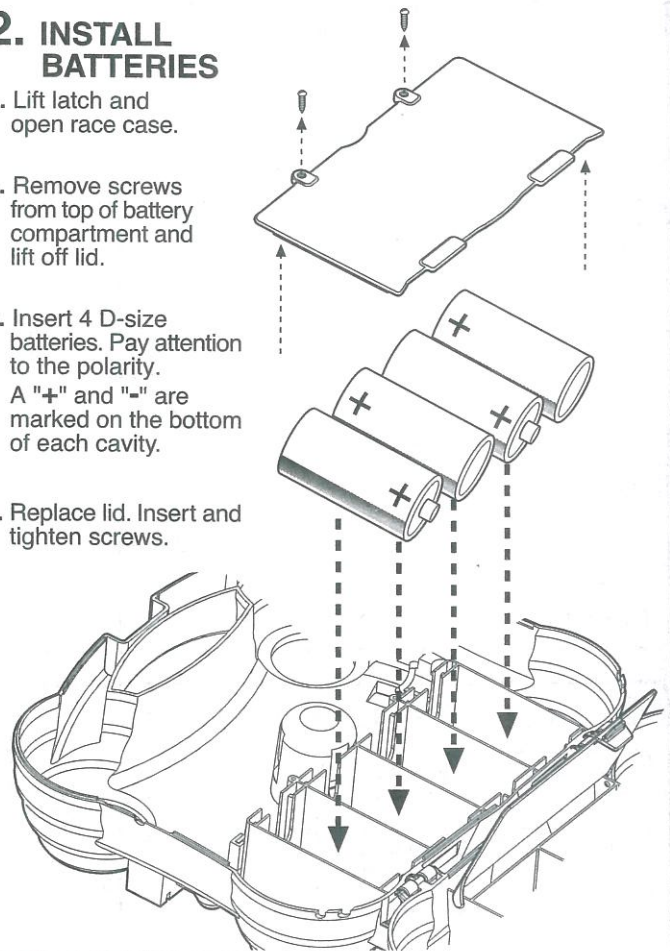

CAUTION:

- Use only alkaline batteries
- Insert batteries into unit in the correct polarity.
- Do not use rechargeable batteries in the unit.
- Do not mix alkaline, standard (carbon - zinc) or rechargeable batteries.
- Do not mix old and new batteries.
- Remove old or dead batteries from unit.
- If unit will be stored for long periods, remove batteries.
- Never recharge non-rechargeable batteries.
- Only batteries of the same or equivalent type recommended are to be used.
- Do not short-circuit supply terminals.