

Estes-Cox Corp.
1295 H Street, PO Box 227
Penrose, CO 81240-0227

INSTRUCTIONS
KEEP FOR FUTURE REFERENCE

A subsidiary of Hobbico, Inc. *Hobbico*

Made In Zhongshan, Guangdong, China

Contents

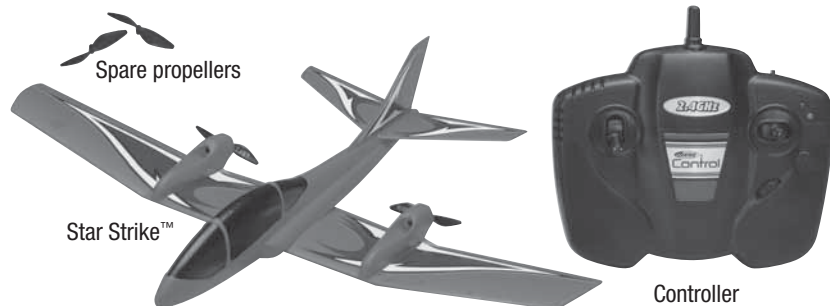

Safety Precautions:

Warning: Do not modify or alter this unit. Changes or modifications to this unit not expressly approved by the party responsible for compliance could void the user's authority to operate the equipment.

- Do not turn on aircraft unless controller has been turned on first.
- Keep hands, hair and loose clothing away from spinning propellers.
- Turn off controller and aircraft when not in use.
- Parental guidance is recommended while flying.
- Do not submerge into water. This could damage electronic assemblies.
- Replace batteries in controller with new ones as soon as any function becomes diminished.
- Follow operating instructions exactly.
- This is not intended for children under 8 years old.
- Do not fly the aircraft if any of the parts are damaged. Repair any damaged or broken parts before attempting to fly.
- Have spectators stand behind and away from the aircraft.

FCC STATEMENT AND INDUSTRY CANADA NOTICE:

1. This device complies with Part 15 of the FCC Rules and RSS-210 of Industry Canada. Operation is subject to the following two conditions:

- (1) This device may not cause harmful interference, and
- (2) This device must accept any interference received, including interference that may cause undesired operation.

2. Changes or modifications not expressly approved by the party responsible for compliance could void the user's authority to operate the equipment.

Remark: This device is in accordance with the digital device grade B limitation and the 15th regulation of FCC. This limitation requires reasonable anti-interference protection around the residence. The device can transmit radio wave during use and can interrupt the mobile communication without proper installment. Interruption will occur for special device. If the device do interrupt the radio or television, please turn the device off then turn it on to adjust. Below are some resolution for your reference:

- Move the receiving antenna
- Enlarge the distance between the device and receiver
- Try to not connect the device and the receiver on the same circuit
- Ask for professional help from experts

3. This digital apparatus does not exceed the Class B limits for radio noise emissions from digital apparatus set out in the Radio Interference Regulations of Industry Canada.

Battery Requirements for Controller:

Requires: 6 x 1.5V AA size batteries (not included)

Care and Maintenance:

- Regularly examine all parts for damage. If any is found, do not use again until the damage has been repaired.

Battery Cautions:

- Parental guidance is recommended when installing or replacing batteries.
- For best performance, use new alkaline batteries in controller.
- Do not power controller by mixing different types of batteries, or old and new batteries.
- Use only batteries of the same or equivalent type as those recommended.

The aircraft is equipped with a rechargeable 3.7V Li-Ion battery. Please pay attention to the following cautions for safe use:

- Do not dispose of battery into fire or heat.
- Do not use or leave battery near a heat source, such as fire or a heater.
- Do not strike battery or throw it against a hard surface.
- Do not immerse battery into water. Keep battery cool and dry.
- Do not directly solder battery or pierce it with a nail or other sharp object.
- Do not transport or store battery together with metal objects such as necklaces, hairpins, etc.
- Do not disassemble or alter battery.
- Recycle used batteries.

- The battery in the aircraft is not replaceable.

CAUTION: Changes or modifications to this product not expressly approved by the party responsible for compliance may void the user's authority to operate the equipment.



Do not touch the spinning propellers or fly over another person's head. Adult supervision is required.



90 DAY LIMITED WARRANTY

PLEASE DO NOT RETURN YOUR PRODUCT TO THE STORE – Estes will repair or replace factory defects for 90 days from the date of purchase. This warranty specifically does not cover crash damage, misuse or abuse. To make a warranty claim, please contact our product support team at 1-217-398-8970 or e-mail us at productsupport@hobbico.com

If requested by Product Support, please send defective product to: Hobby Services, 3002 N Apollo Dr., Suite #1, Champaign, IL 61822

This warranty applies only if the product is operated in compliance with the instructions and warnings provided with each model. Estes assumes no liability except for the exclusive remedy or repair of parts as specified above. Estes shall not be liable for consequential or incidental damages. Some states do not allow the exclusion of consequential or incidental damages so the above exclusion may not apply to you. This warranty gives you specific legal rights and you may also have other rights which vary from state to state.

Wing Installation Instructions

1. Peel tape backing.

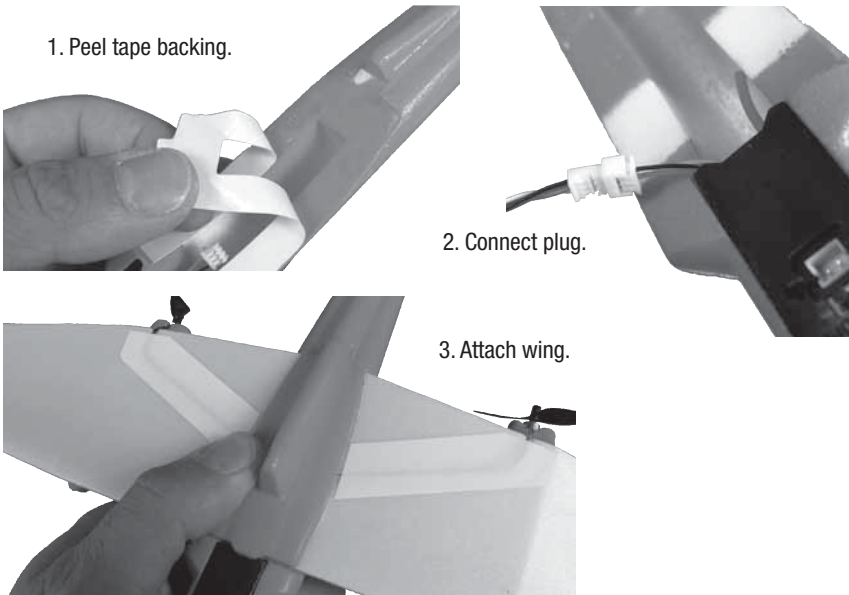

2. Connect plug.

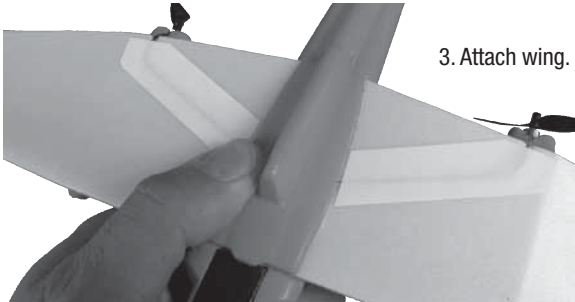

3. Attach wing.

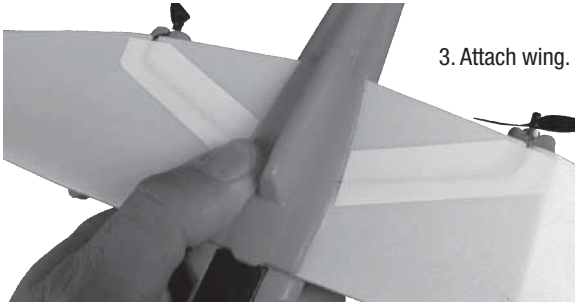

Controller with Built-in Charger



Remove screw and back cover. Insert 6 new "AA" alkaline batteries in the correct polarity. Replace cover and screw. New batteries should be installed after every fourth complete charge of the Star Strike.

Throttle Stick:

Push and hold up for full motor power. Push halfway up for cruising speed. Release to stop.



Binding Button
Power LED (red)
Charger LED (green)

Direction Stick:
Tap (push and release) left or right to steer.

Flight Direction Trim:
Adjusts the right and left direction.

Switch "ON" for flying
Switch "CHG" for charging

Charge the Aircraft

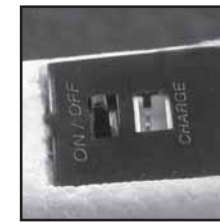

1. Turn aircraft off and controller to CHG.

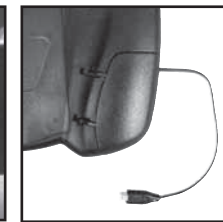

2. Open controller charging door. Extend charge cord.

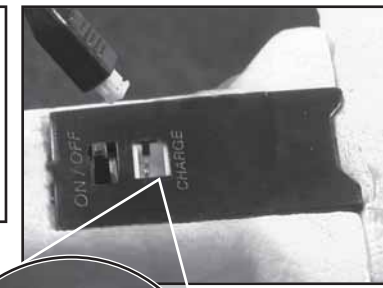

3. Plug charge cord into aircraft (DO NOT FORCE OR PLUG BACKWARDS). The green controller LED glows.



4. Charge until green LED turns off. Unplug cord and store in controller charge compartment.



NOTE: While charging, heat is released through the controller vents. Never cover the vents.

Flying Your Aircraft

STEERING AN AIRCRAFT COMING TOWARD YOU

1. Imagine you're in the cockpit. Turn and point the controller antenna in the direction the aircraft is flying. **OR**
2. While the aircraft's wing is banked, tap the direction control stick in the direction of the low wing until it levels.



To stop turning, tap the direction control stick in the low wing's direction.

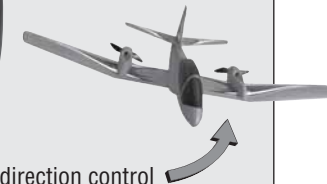

LANDING THE AIRCRAFT

Release the throttle control stick to begin descent. Tap the direction control stick left or right to steer into the wind and keep the wings level.

Tap the throttle control stick to keep the aircraft on a gentle path to touchdown.

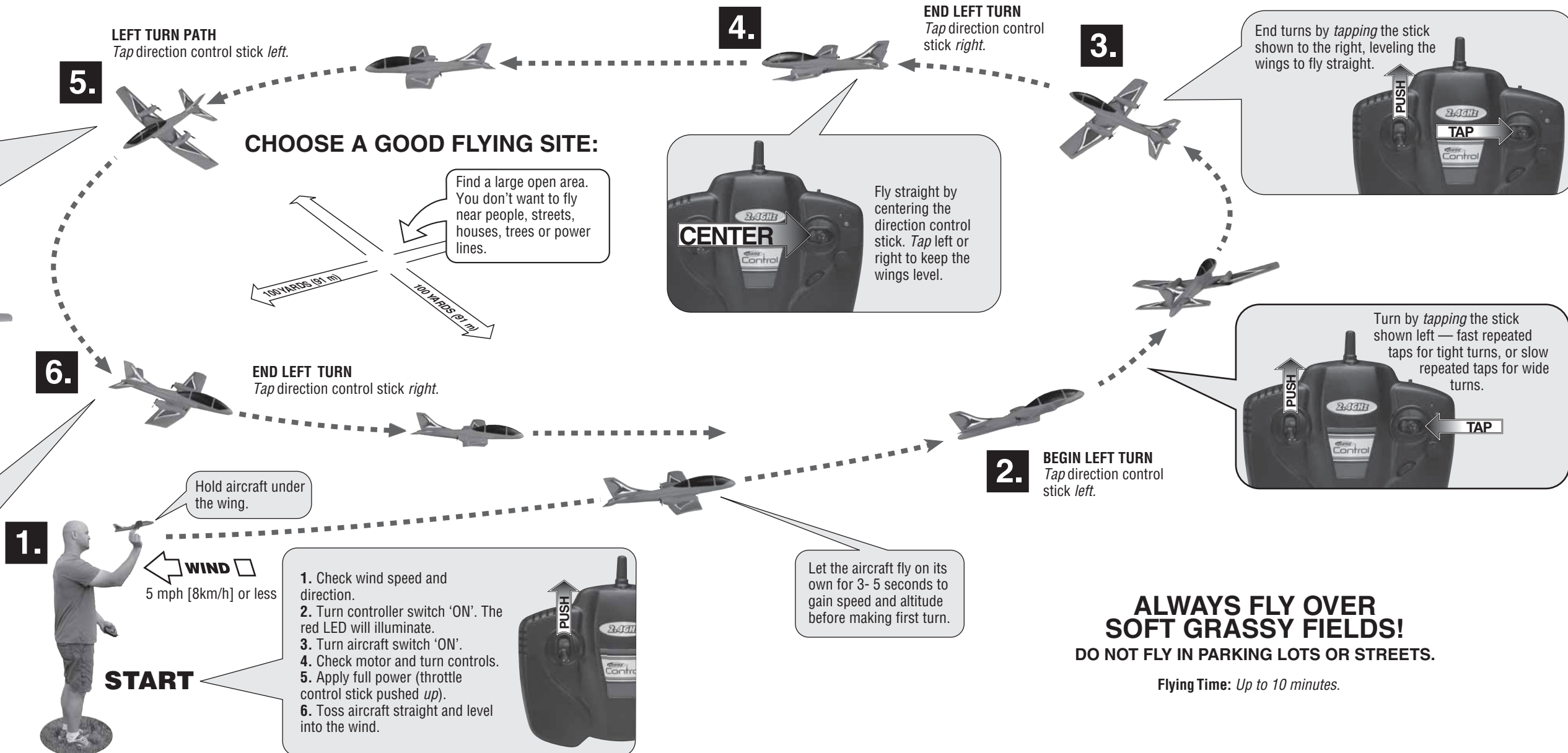
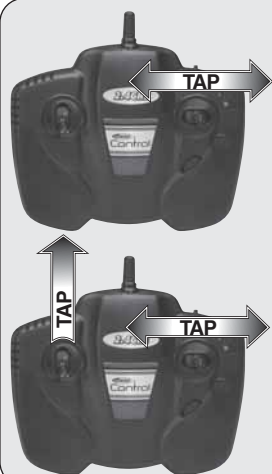

ALWAYS FLY OVER SOFT GRASSY FIELDS!
DO NOT FLY IN PARKING LOTS OR STREETS.

Flying Time: Up to 10 minutes.

Troubleshooting

Problem	Cause
Motors will not operate	<ul style="list-style-type: none">• Aircraft not charged.• Controller battery power is drained.• Aircraft not turned 'ON'.• Aircraft not bound to controller.
Aircraft is flying too low	<ul style="list-style-type: none">• Aircraft not fully charged.• Apply full power.
Aircraft will not turn	<ul style="list-style-type: none">• Controller is not turned 'ON'.• Flying in too strong of wind.• Model has flown out of controller range.

Binding Procedure

If the controller can no longer communicate with the aircraft, it may need to be "bound" again following the procedure below:

1. Press and hold binding button on top right of controller
2. Turn on controller
3. Turn on aircraft
4. Release binding button
5. Confirm that the controller now controls the aircraft

Easy Repairs

If crash damage occurs, your aircraft may easily be repaired using household tape and glue. Clear packing tape works well for most repairs; however, larger breaks may require glue and tape for best results. Use 5-minute epoxy or household white glue and allow the glue to dry fully undisturbed.

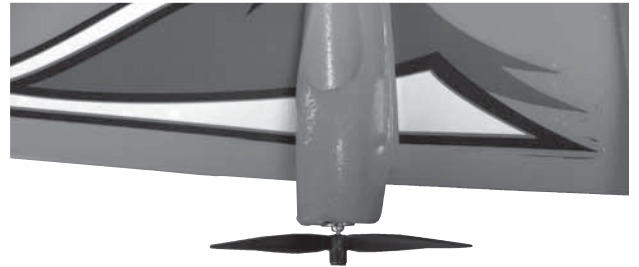
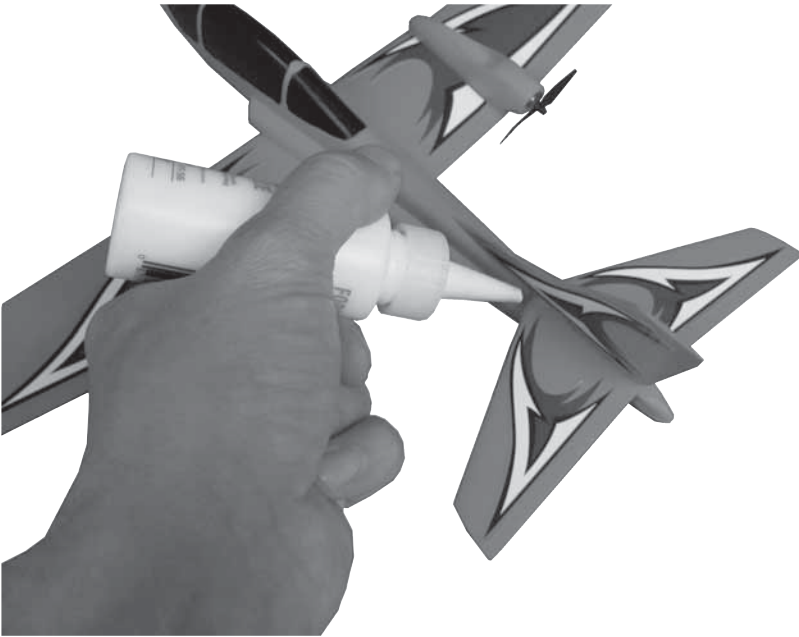

To replace a broken propeller: Use small needle nose pliers to pry off a broken propeller from the motor shaft. Press the replacement propeller onto the motor shaft in the orientation shown in the photo.

There is a left and right propeller. If the propeller thrust is backwards with throttle applied, swap it with the other replacement propeller.

Service

If your aircraft requires repairs or replacement, **DO NOT RETURN TO RETAILER.** Contact:

Hobby Services
3002 N. Apollo Drive, Suite 1
Champaign, IL 61822, U.S.A.
9am-5pm Central Mon.-Fri.
(217) 398-0007
hobbyservices@hobbico.com



PN067049 (3-14)

© 2014 Estes-Cox Corp. A subsidiary of Hobbico, Inc. **HOBBICO**